

GCL-LJ **Light Duty Operator**

Model OPGLDJ0011RLS for Sheet Doors with Live Shaft
Model OPGLDJ0011RDS for Sheet Doors with Dead Shaft
Model OPGLDJ0011RSH for Shutter Door Applications



Light Duty Jackshaft Operator



NOT FOR RESIDENTIAL USE

This installation manual provides the information required to install, program, troubleshoot, and maintain a GCL-LJ operator.

SERIAL NUMBER DECAL

PLACE iDCM SERIAL NUMBER DECAL HERE IF Optional
iDCM KIT IS INSTALLED

INDEX

1	General Information & Instructions: 1	4	Programming Operator And Accessories:
	Safety & General Information:		Introduction..... 24
	Safety Information and Instructions 2-3		Adjusting For Door Type 25
	Important Installation Instructions 4		Setting Down Limit..... 27
	Approved Safety Devices 5		Setting Up Limit..... 28
2	Operator Installation:		Setting Force Control 29
	Pre-Installation Considerations..... 6		Programming Additional Remote Controls (Optional) .. 30
	Pre-Installation Permanent Input Wiring..... 7		Programming Mid-Stop (Optional) 31
	Installing Operator 8-13		Programming Time-to-Close (Optional) 32
3	Wire Operator, Install & Wire Accessories:	5	Special Installation Information:
	Install And Wire Monitored Safety Device..... 14		Changing Force Settings..... 33
	Install and Wire Monitored Photocells (Std. Equip.) 14		Clearing Remote/Accessory Memory..... 34
	Wired Monitored Reflective Photocells (Optional)..... 14		Locating Safe-T-Beam® (multiple doors) 35
	Wired NEMA 4X Photocells (Optional) 15		Safe-T-Beam® Troubleshooting 35
	Wired Monitored Light Curtain (Optional) 16		Programming Accessories:
	Wired Safety Edge Instructions (Optional) 17		Programming Aladdin Connect® (Optional)..... 36-37
	Wireless Safety Edge Instructions (Optional)..... 18		Wireless Keypad 38
	Install and Wire Open/Close/Stop Pushbutton 19		Programming Vehicle Controls 39
	Install LED Light Fixture (Optional) 20	6	Maintenance:
	Install Wireless Wall Console (Optional) 20		Important Safety Instructions 40
	Install and Wire Wired Wall Console (Optional) 21		Regular Maintenance Schedule 41
	Install and Wire External Interlock (Optional) 21		Door Inspection & Maintenance..... 41
	Install Bottom Cover..... 21		Remote Battery Replacement..... 41
	Installing Battery Back Up (Optional) 22	7	Troubleshooting & LED Signals 42-44
	Apply Power to Operator 23	8	Replacement Parts 45-47
			Warranty 49

For patent information visit www.geniecompany.com/patents.

SAVE THESE INSTRUCTIONS

READ AND FOLLOW ALL INSTRUCTIONS

FCC Part 15.21 Statement:

Changes or modifications not expressly approved by the party responsible NOTE: for compliance could void the user's authority to operate the equipment.

FCC / IC Statement:

This device complies with FCC Part 15 and Industry Canada licence-exempt RSS standard(s). Operation is subject to the following two conditions: (1) this device may not cause harmful interference, and (2) this device must accept any interference received, including interference that may cause undesired operation of the device.

Le présent appareil est conforme aux CNR d'Industrie Canada applicables aux appareils radio exempts de licence. L'exploitation est autorisée aux deux conditions suivantes : (1) l'appareil ne doit pas produire de brouillage, et (2) l'utilisateur de l'appareil doit accepter tout brouillage radioélectrique subi, même si le brouillage est susceptible d'en compromettre le fonctionnement.

1 GENERAL INFORMATION AND INSTRUCTIONS

Job Site Issues to Consider/Concerns

The following list of items should be considered prior to selecting an operator for a given job site:

1. Available power supply.
2. Type of door.
3. Potential operator mounting obstructions. Items to consider include, but are not limited to: Room above door shaft, room below door shaft, available mounting surface integrity, power supply location, and convenient release cable positioning.
4. Size of door for appropriate operator torque and door travel speed selection.
5. Operator mounting environment. Items to consider include operator location, and temperature, dampness, dustiness or corrosiveness of the location.
6. Door activation needs/requirements. Examples include 3 button control stations, 1 button control stations, radio controls, pull cords, photoelectric controls, key switches, etc. See ENTRAPMENT PROTECTION section.
7. Interlock switches are required under certain conditions for doors with pass doors, door lock and dock levelers.
8. Accessory equipment. Examples include reversing edges and/or photocells, which are required for doors set to operate as momentary contact, etc. See ENTRAPMENT PROTECTION section.

CAUTION

Check working condition of door before installing the operator. Door must be free from sticking and binding. If equipped, deactivate any door locking device(s). Door repairs and adjustments, including cables and spring assemblies **MUST** be made by a trained service representative using proper tools and instructions.

ATTENTION

Vérifiez l'état de fonctionnement de la porte avant d'installer l'opérateur. La porte doit pouvoir bouger librement et ne pas coincer. Désactivez tous les dispositifs de verrouillage de la porte (si équipés). Les réparations et les réglages de porte, plus particulièrement pour les câbles et les ressorts **DOIVENT** être effectués par un technicien qualifié qui se sert d'outils appropriés et qui respecte les instructions.

WARNING

DO NOT apply line voltage until instructed to do so.

AVERTISSEMENT



NE PAS mettre sous tension tant que l'instruction n'est pas donnée de le faire.

SAFETY INFORMATION AND INSTRUCTIONS







WARNING

Commercial Doors are large, heavy objects that move with the help of springs under high tension and electric motors. Since moving objects, springs under tension, and electric motors can cause injury, your safety and the safety of others depend on you reading the information in this manual. If you have any questions or do not understand the information presented, call your nearest service representative. For the number of your local Genie Dealer at 1-800-OK-GENIE.

In this manual the words Danger, Warning, and Caution are used to stress important safety information. The word:

-  **DANGER** indicates an imminently hazardous situation which, if not avoided, will result in death or serious injury.
-  **WARNING** indicates a potentially hazardous situation which, if not avoided, could result in death or serious injury.
-  **CAUTION** indicates potentially hazardous situation which, if not avoided, may result in injury or property damage.

The word **NOTE** is used to indicate important steps to be followed or important considerations.

POTENTIAL HAZARD	EFFECT	PREVENTION
MOVING DOOR 	 WARNING Could result in Serious Injury or Death	Do Not operate unless the doorway is in sight and free of obstructions. Keep people clear of opening while door is moving. Do Not allow children to play with the door operator. Do Not change operator control to momentary contact unless and external monitored reversing means is installed. Do Not operate a door that jams or one that has a broken spring.
ELECTRICAL SHOCK 	 WARNING Could cause Serious Injury or Death	Turn off electrical power before removing operator cover. When replacing the cover, make sure wires are not pinched or near moving parts. Operator must be electrically grounded.
HIGH SPRING TENSION 	 WARNING Could cause Serious Injury or Death	Do Not try to remove, repair, or adjust springs or anything to which door spring parts are fastened, such as wood block, steel bracket, cable, or any other structure or like item. Repairs and adjustments must be made by trained service representative using proper tools and instructions.

IMPORTANT

READ PRIOR TO ANY DOOR OPERATION

1. Read manual and warnings carefully.
2. Keep the door in good working condition. Periodically lubricate all moving parts of door.
3. If door has a sensing edge, check operations monthly. Make any necessary repairs to keep it functional.
4. AT LEAST twice a year, manually operate the door by disconnecting it from the operator. The Door should open and close freely. If it does not, the door must be taken out of service and a trained service representative must correct the condition causing the malfunction.
5. The Operator Motor is protected against overheating by an internal thermal protector. If the motor protector is tripped, a trained service technical may be needed to correct the condition which caused the overheating. When the motor has cooled, thermal protector will automatically reset and normal operation can be resumed.
6. In case of power failure, the door can be operated manually by pulling the release cable to disconnect the operator drive system.
7. Keep instructions in a prominent location near the pushbutton.

SAFETY INFORMATION AND INSTRUCTIONS



⚠️ AVERTISSEMENT

Les portes motorisées sont grandes objets lourds qui fonctionnent à l'aide de ressorts soumis à une haute tension et de moteurs électriques. Dans la mesure où les objets en mouvement, les ressorts sous tension et les moteurs électriques peuvent entraîner des blessures, votre sécurité et celle des autres exigent que vous preniez connaissance des informations stipulées dans ce manuel. Si vous avez des questions ou si vous ne comprenez pas les informations ci-incluses, veuillez contacter le représentant de service le plus près. Pour obtenir le numéro du revendeur Genie local, appelez le +1 (800)-OK-GENIE.

Dans ce manuel, les mots Danger, Avertissement, et Attention sont utilisés pour faire ressortir d'importantes informations relatives à la sécurité. Le mot:

- ⚠️ **DANGER** signale une situation dangereuse imminente qui si elle n'est pas évitée, risque d'entraîner des blessures graves, voire mortelles.
- ⚠️ **AVERTISSEMENT** signale une situation potentiellement dangereuse qui, si elle n'est pas évitée, risque d'entraîner la mort ou des blessures graves.
- ⚠️ **ATTENTION** signale une situation potentiellement dangereuse qui, si elle n'est pas évitée, risque d'entraîner des blessures ou des dommages matériels.

Le terme **REMARQUE** est utilisé pour signaler les étapes importantes à suivre ou d'importants éléments à prendre en considération.

DANGER POTENTIEL	EFFET	PRÉVENTION
PORTE EN MOUVEMENT 	⚠️ AVERTISSEMENT Pourrait entraîner des blessures graves voire la mort	Utiliser uniquement si la porte est en vue et libre de tout obstacle. Ne laisser personne se tenir dans l'ouverture de la porte pendant qu'elle est en mouvement. Ne pas permettre aux enfants de jouer avec l'opérateur de la porte. Ne pas modifier la commande de l'opérateur à contact momentané à moins qu'un moyen d'inversion externe soit installé. Ne pas faire fonctionner une porte qui bloque ou dont le ressort est cassé.
CHOC ÉLECTRIQUE 	⚠️ AVERTISSEMENT Pourrait entraîner des blessures graves voire la mort	Couper le courant avant d'enlever le couvercle de l'opérateur. Lorsque le couvercle doit être remplacé, s'assurer que les fils ne sont ni coincés ni près des pièces mobiles. L'opérateur doit être correctement mis à la terre.
TENSION ÉLEVÉE RESSORT 	⚠️ AVERTISSEMENT Pourrait entraîner des blessures graves voire la mort	Ne pas essayer d'enlever, réparer, ni ajuster les ressorts ou toute autre pièce à laquelle le ressort de la porte est attaché, y compris blocs de bois, supports en acier, câbles, ou autres articles semblables. Les réparations et les réglages doivent être effectués par technicien qualifié qui se sert d'outils appropriés et qui respecte les instructions.

CRITICAL INSTALLATION INFORMATION

IMPORTANT INSTALLATION INSTRUCTIONS

WARNING **To reduce the risk of severe injury or death:**

1. READ AND FOLLOW ALL INSTALLATION INSTRUCTIONS.
2. Install only on a properly operating and balanced door. A door that is operating improperly could cause severe injury. Have qualified service personnel make repairs to cables, spring assemblies and other hardware before installing the operator.
3. Remove all pull ropes and remove, or make inoperative, all locks (unless mechanically and/or electronically interlocked to the operator) that are connected to the door before installing the operator.
4. Install the door operator at least 8ft. (2.44m) or more above the floor, if operator has exposed moving parts. If the operator must be installed less than 8ft. (2.44m) above the floor, then exposed moving parts must be protected by covers or guarding.
5. Do not connect the door operator to the power source until instructed to do so.
6. Locate the control station: (a) within sight of the door, (b) a minimum of 5 feet above the floor so that small children cannot reach it, and (c) away from all moving parts of the door.
7. Install the Entrapment Warning Placard next to the control station and in a prominent location.
8. For products having a manual release, instruct the end user on the operation of the manual release.

IMPORTANT INSTRUCTIONS D'INSTALLATION

AVERTISSEMENT **Pour réduire les risques de blessures graves ou de mort:**

1. LIRE ET RESPECTER TOUTES LES INSTRUCTIONS D'INSTALLATION.
2. Installez uniquement sur une porte fonctionnant correctement et bien équilibrée. Une porte qui fonctionne mal peut provoquer des blessures graves. Demandez à un technicien qualifié d'effectuer les réparations des câbles, des ressorts et de toute autre quincaillerie avant de procéder à l'installation de l'opérateur.
3. Retirez toutes les cordes de traction ainsi que tous les verrous ou rendez-les inopérants (à moins qu'ils ne soient mécaniquement et/ou électroniquement interverrouillés à l'unité motrices) qui sont connectés à la porte avant de procéder à l'installation de l'opérateur.
4. Installez l'opérateur de porte à une distance de 2,44 m (8 pi) ou plus au-dessus du sol si des pièces en mouvement de l'opérateur sont exposées. Si l'opérateur doit être installé à une distance de moins de 2,44 m (8 pi) au-dessus du sol, les pièces en mouvement exposées doivent être protégées par des couvercles ou systèmes de protection fournis par le fabricant de l'opérateur.
5. Ne pas raccorder l'opérateur de la porte à la source d'alimentation avant que l'instruction ne soit donnée de le faire.
6. Installez la station de commande : (a) en vue de la porte, (b) à 1,5 m minimum au-dessus du sol pour que les jeunes enfants ne puissent pas l'atteindre, et (c) à l'écart de toutes les pièces mobiles de la porte.
7. Installez le poster d'avertissement de pincement à côté de la station de commande à un endroit bien en vue.
8. Pour les produits ayant un déclenchement manuel, indiquez à l'utilisateur comment déclencher manuellement.

CRITICAL INSTALLATION INFORMATION

IMPORTANT INSTALLATION INFORMATION

ENTRAPMENT PROTECTION:

The installation of a monitored fail-safe external reversing device is required on all momentary contact electronically operated commercial doors. If such a reversing device is not installed, the operator will revert to a constant contact control switch for close operation.

Reversing devices currently UL Approved for use with this model are:

<i>Standard Commercial Photocells with Extendable Brackets</i>	
38176R.S	KIT, PHOTOCELLS, COMMERCIAL (STANDARD EQUIP.)
<i>Protected Commercial Photocells with Extendable Brackets</i>	
OPAKPE2.S	KIT, PHOTOCELLS W/COMM BRKT
<i>NEMA 4X Photocells</i>	
OPAKPEN4GX.S	KIT, PHOTOCELLS, NEMA-4X,50 FT
<i>Retro Reflective N4X Photocells</i>	
OPGAKRPEN4X.S	KIT, PHOTOCELLS, REFLECTIVE, GENIE
<i>Monitored Light Curtains (Powered with Transformer 36238A)</i>	
OPAKMLC3.S	KIT, LIGHT CURTAIN, 3FT
OPAKMLC6.S	KIT, LIGHT CURTAIN, 6FT
<i>DC/T3 Monitored Edge Interface Adapter (Commercial Applications Only)</i>	
OPAKMEIGX.S	KIT, MONITORED EDGE X-SERIES Genie
<i>Wireless Edge Kit (Powered with Transformer (36238A) (Commercial Applications Only)</i>	
OPAKRWET2.S	KIT, XMTR/RCVR, SENSING EDGE, WIRELESS, T2
OPAKRWET3.S	KIT, XMTR/RCVR, w/CONVERTER, SENSING EDGE, WIRELESS, T3

Compatibility Considerations:

The Genie® Light Duty Commercial Jackshaft Operator for Rolling Doors is intended for use on:

- Sheet Doors with Live Shaft, a minimum 9" diameter counterbalance wrap, maximum 10' door height, and 100 sq. ft. door.
- Sheet Doors with Dead Shaft, a minimum 12" diameter counterbalance wrap, maximum 20' door height, and 320 sq. ft. door.
- Shutter doors per the following table:

		Commercial Shutter Doors						
		HEIGHT (FT)						
		6	7	8	9	10	11	12
WIDTH (FT)	6							
	7							
	8							
	9							
	10							
	11							
	12							
	13							
	14							
	15							
16								

Recommended Closing Speed/ Compatibility Legend		
Low Speed		
Medium Speed		
High Speed		
Not Compatible		

For further instructions, see Pages 25 & 26.

- Maximum range of the operator is 13 full turns of the output shaft.
- DO NOT use on sectional doors.

⚠ WARNING

Garage door hardware (springs, cables, brackets, pulleys, etc.) are under extreme pressure and tension.

DO NOT attempt to repair or adjust door springs or any hardware, and **DO NOT OPERATE** garage door automatically or manually if door is improperly balanced or springs are broken.

CONTACT A TRAINED DOOR SYSTEM TECHNICIAN.

⚠ AVERTISSEMENT

La quincaillerie de la porte de garage (ressorts, câbles, supports, poulies, etc.) sont sous des pressions et des tensions extrêmes.

NE PAS réparer ni régler les ressorts de la porte ou toute autre pièce de quincaillerie et **NE PAS ACTIONNER** la porte manuellement ou automatiquement si elle n'est pas correctement équilibrée ou si des ressorts sont cassés.

CONTACTEZ UN TECHNICIEN SPÉCIALISÉ EN SYSTÈME DE PORTES.

Door Inspection:

If the intended door meets the above requirements, inspect the door for proper balance and general condition.

- Raise and lower the door manually. Door should move freely and smoothly.
- Raise door manually about 3' to 4' feet from floor and let go. Door should remain stationary or slowly drift closed. FIG.A.
If door opens or closes rapidly, CONTACT A TRAINED DOOR SYSTEM TECHNICIAN to have your door springs serviced.
- If manual door locks will be used they require interlock switches wired to the interlock terminals of the operator to prevent motor operation when the manual locks are engaged.
- Monitor the end of the door shaft while the door is raised and lowered. It is important that there is no noticeable movement up and down or side to side, if there is, CONTACT A TRAINED DOOR SYSTEM TECHNICIAN, otherwise operator reliability will be significantly reduced.

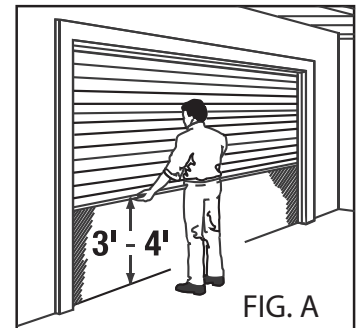

PRE-INSTALLATION CONSIDERATIONS

Input Power Options:

A. 115 VAC plug Provided with Operator

1. A 115 VAC power outlet must be available within 5' from bottom of the operator when mounted to door.
2. Continue installation starting on page 8.

B. Power Extension Kit P/N: 41194R

The power extension kit includes a 115 VAC plug, transformer box, 30' of low voltage cable, and a circuit board that replaces the transformer in the operator. This kit may be installed by a garage door technician in jurisdictions which do not require a licensed electrician to install low voltage circuits.

3. Follow installation instructions included with the power extension kit.
4. Continue installation starting on page 8.

C. Permanent wiring should be completed by a trained electrician only:

1. Remove two screws from bottom of cover and remove main operator cover/circuit board assembly.
2. Unplug wire harnesses from main board.
3. Unplug input power cable connector from transformer input.
4. Remove transformer from chassis.
5. Remove strain relief and pull power cable from operator.
6. Install operator per instructions on pages 8 through 13.
7. Cut power cable wires and strip insulation from power cable input harness connector end.
 - All wire connections must be made **INSIDE CHASSIS** and there must be at least 3" of new power supply line wire inside chassis.
 - Check local code for the use of conduit or other protective material.
 - Conduit, fittings/strain relief, and wire nuts are not provided.
8. Install 1/2" NPT or other suitable connector into chassis. (Adhere to local electrical code(s) and regulations)
9. Connect permanent power input cable to harness wires using approved connectors or wire nuts (Adhere to local electrical code(s) and regulations)
10. Install ground connector to permanent power cable ground wire.
11. Install ground screw and power cable ground onto chassis.
12. Plug power input harness into transformer harness.
13. Install transformer.
14. Ensure input power cable and connections do not interfere with internal moving components.
15. Plug all harnesses into main control board and install cover assembly.
16. **DO NOT APPLY POWER AT THIS TIME.**
17. Continue installation starting on page 8.

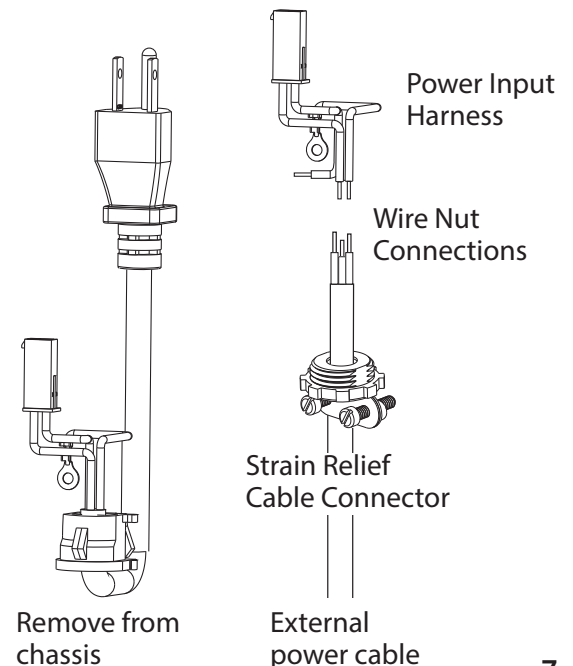
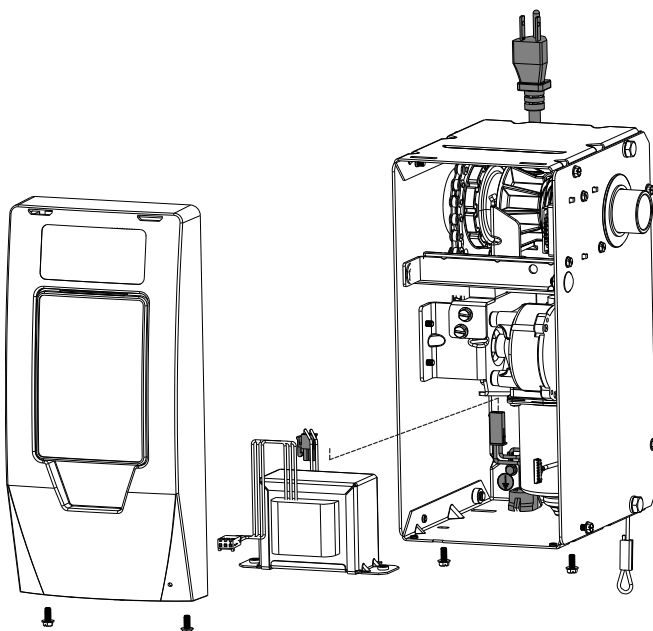

PREPARE OPERATOR FOR INSTALLATION

Sheet Door - Live Shaft - Direct Coupled

1. Close the door.
2. Remove the lower fastener from the powerhead chassis and set aside.
3. Install the Coupler onto the operator output shaft and against the bearing.
 - Tighten or loosen all set screws until they are flush with the coupler's internal bore. (See **Section A-A**).
 - Add 1 full turn to the operator output shaft set screws in 1/4 turn increments.

NOTE: Coupler set screws include thread locking compound.

NOTE: Coupler set screws use a 1/2" wrench or socket.

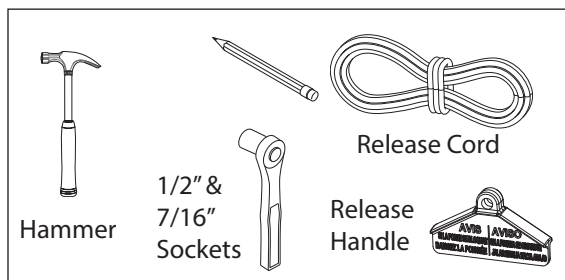
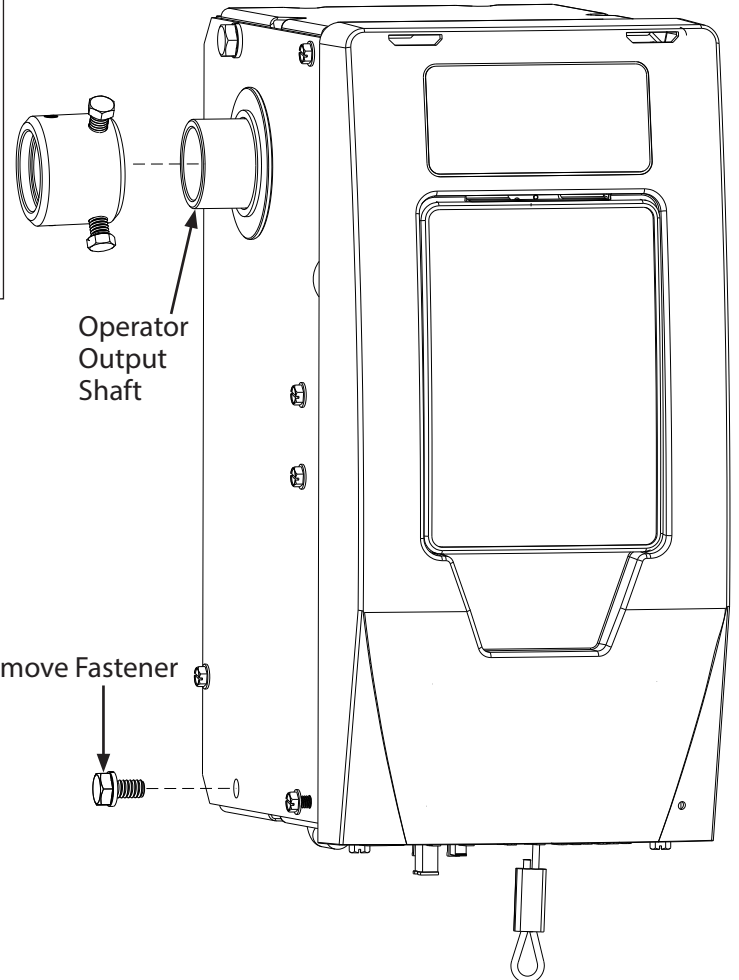
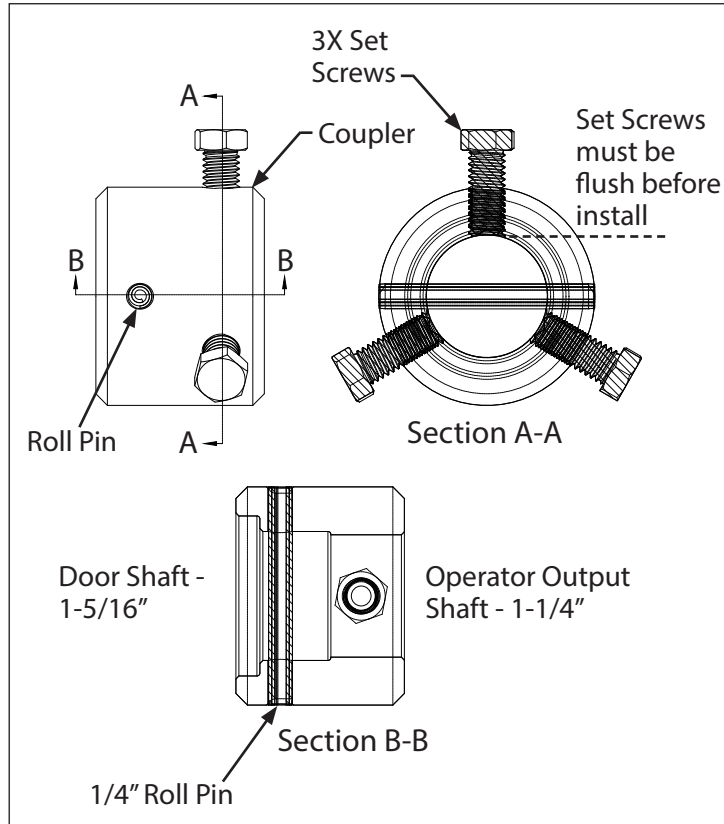

INSTALLING THE OPERATOR

4. Mount the operator to the door shaft.
 - Slide the operator assembly onto the door shaft.
 - Pull the emergency release cable at the bottom of the operator to allow free rotation of the output shaft to “clock” the through hole on the shaft with the through hole on the coupler. Install the Roll Pin through these holes. Alternate method: Use a 3/16” (5 mm) Allen wrench to align the holes, and install the roll pin.
6. Level and square the operator.
7. Install the lower mounting fastener through the door mounting bracket (See Door manufacturer instructions) and into the operator chassis. Tighten the mounting fasteners to the operator.

NOTE: Ensure all coupler set screws are secured prior to tightening the mounting bracket bolt.

8. Manually operate the door to inspect for binding.
9. Tie the red emergency release cord to the cable loop, and tie the release handle to the cord approximately 5' from the floor.

NOTE: Operator **MUST** be mounted to the mounting plate included with the door.

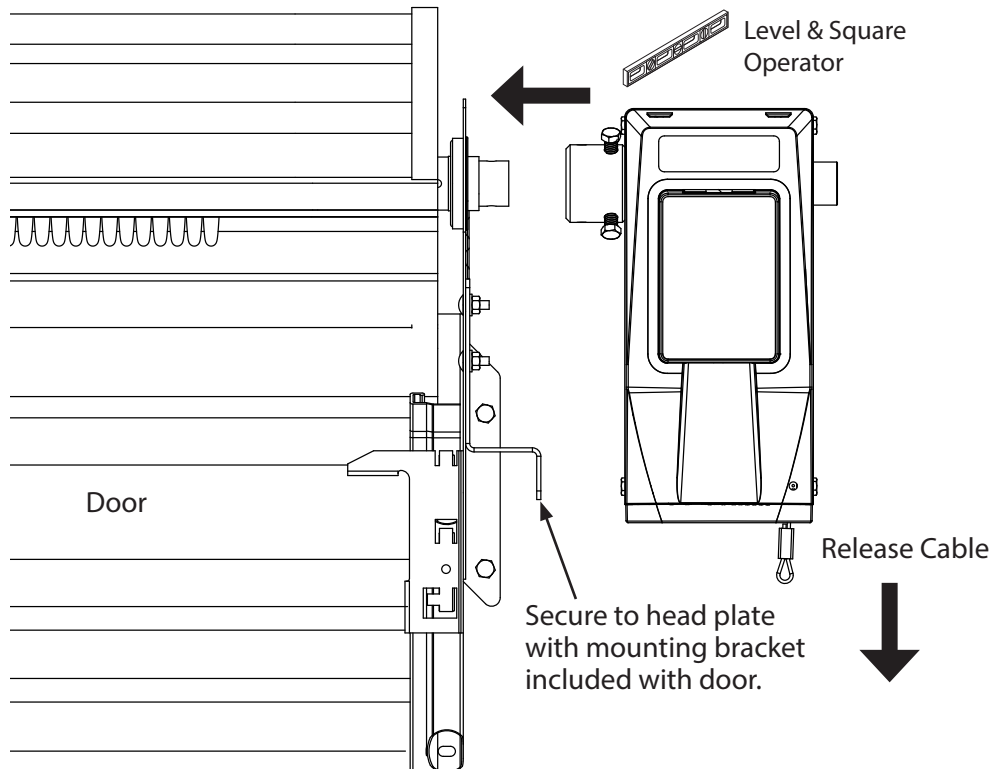
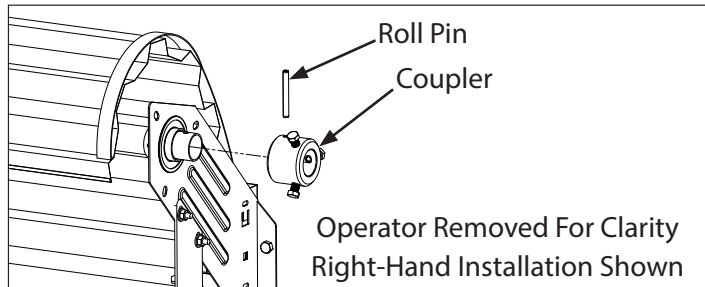

PREPARE OPERATOR FOR INSTALLATION

Sheet Door - Dead Shaft - Chain Coupled

1. Close the door.
2. Remove the fasteners from the powerhead chassis and loosely install the mounting brackets from the kit bag, one on each side of the powerhead.
3. Install the Coupler
 - Tighten or loosen all set screws until they are flush with the coupler's internal bore or top of keyway. (See **DETAIL A**).

NOTE: Coupler set screws include thread locking compound.

NOTE: Coupler set screws use a 1/2" wrench or socket.

NOTE: The coupler must be installed onto the operator output shaft until the coupler seats completely to the recess inside the coupler (See Detail A).

4. Install the Sprocket (14T) onto the 6" long Solid Shaft. Insert the provided key into the keyway and tighten the set screws.
5. Install the Solid Shaft assembly to the Operator. Insert the provided key into the keyway. Pull the emergency release cable at the bottom of the operator to allow free rotation of the output shaft to "clock" the keyways together.

NOTE: The mounting of this operator to the shaft is designed so the shaft will slide through the coupler and enter the hollow output shaft of the operator up to 3-7/16" (there is a stop pin located in the center of the operator output shaft). The minimum distance the shaft should be inserted is 1-7/8".

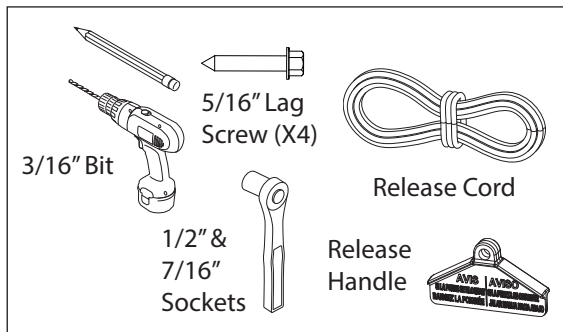
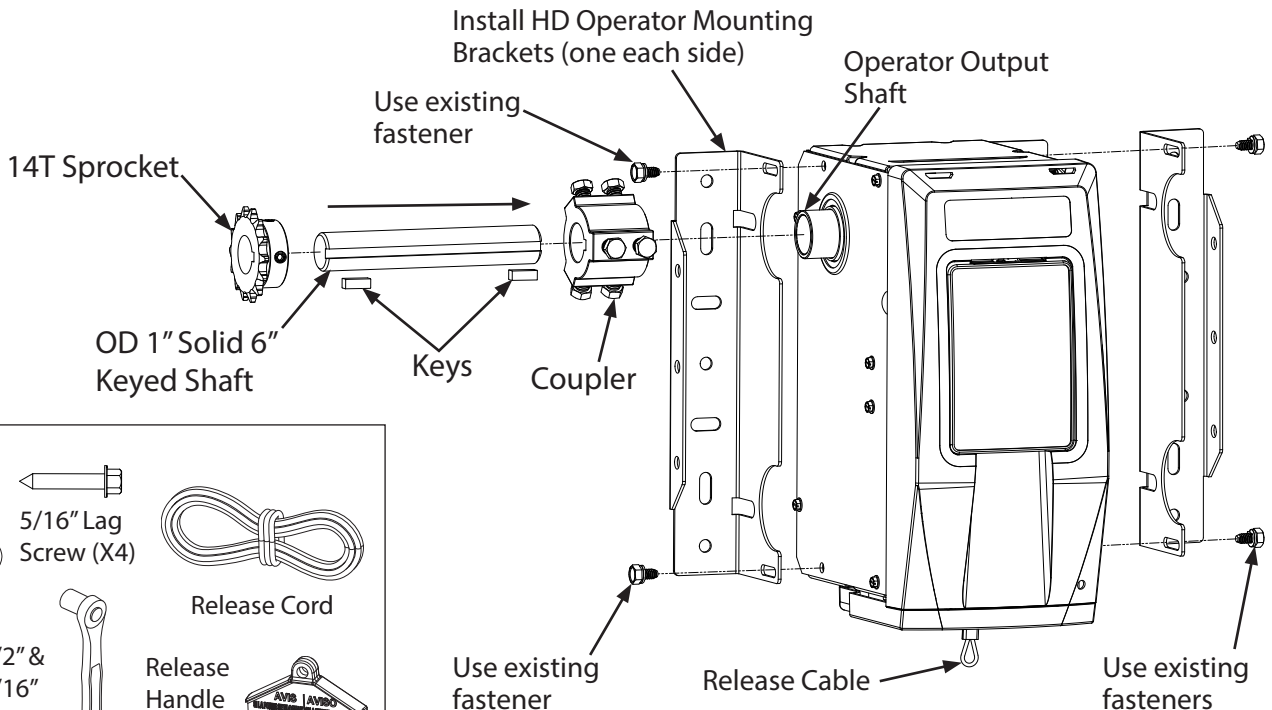
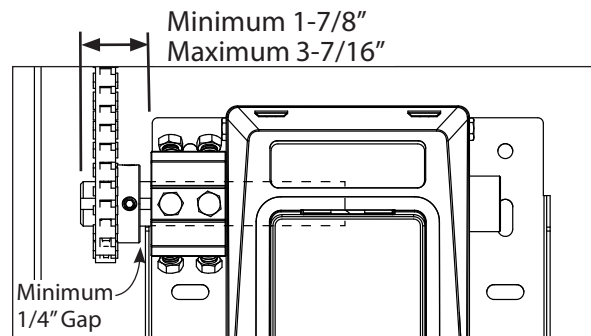
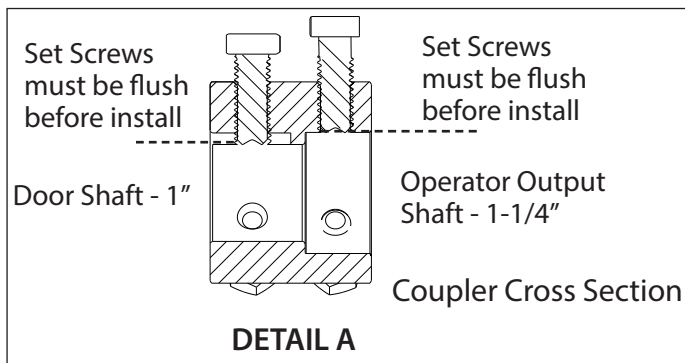

INSTALLING THE OPERATOR

6. Position the operator assembly so that the small sprocket and large sprocket are aligned, and allows for proper tension on the chain.
7. Level and square the operator. Tighten the mounting bracket fasteners to the operator.
8. Mark the mounting bracket hole position on the wall, pre-drill a 3/16" pilot hole, install a lag screw, and fully tighten. Repeat this step for the other 3 lag screws.
9. Align the sprockets by adjusting the solid shaft location side to side. The shaft must be inserted a minimum of 1-1/2", with a gap of 1/4" between the coupler and the small sprocket.
10. For Operator output shaft set screws, add 1 full turn in 1/4 turn increments.
For a solid door shaft, add 1/2 turn in 1/4 turn increments.

NOTE: Ensure all coupler set screws are secured prior to tightening the mounting bracket bolts.

11. Pull the emergency release cable and manually operate the door to inspect for binding.
12. Tie the red emergency release cord to the cable loop and tie the release handle to the cord approximately 5' from the floor.

NOTE: Operator **MUST** be mounted to garage framing material. **DO NOT** install to particle board or drywall. The instructions above are provided using standard wood framing and bracing. Additional bracing may be required for this installation. Hardware for masonry or steel construction is not provided.

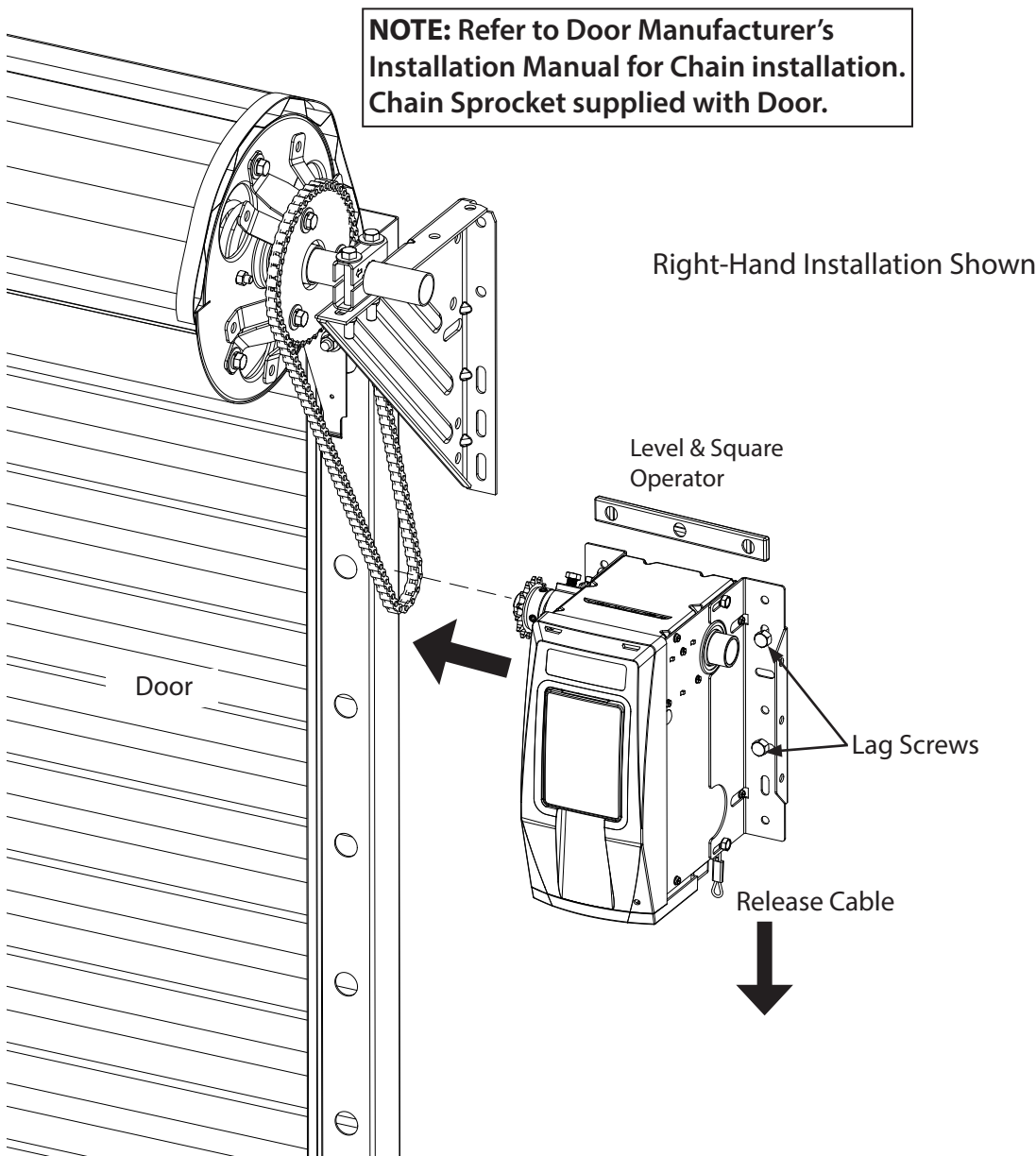

PREPARE OPERATOR FOR INSTALLATION

Shutter Doors - Direct Coupled

1. Close the door.
2. Remove the fastener from the powerhead chassis and loosely install the mounting bracket from the kit bag on the desired side of the powerhead. (right hand mount shown).

NOTE: Bracket can be mounted to operator on either side depending on mounting requirements.

3. Install the Coupler onto the Operator output shaft.
 - Tighten or loosen all set screws until they are flush with the coupler's internal bore or top of keyway if using on solid shaft with a keyway. (See **DETAIL A**).
 - Tighten the set screws on the Operator shaft until they contact the shaft.

NOTE: Coupler set screws include thread locking compound.

NOTE: Coupler set screws use 1/2" wrench or socket.

NOTE: The coupler must be installed onto the operator output shaft until the coupler seats completely to the recess inside the coupler (See Detail A).

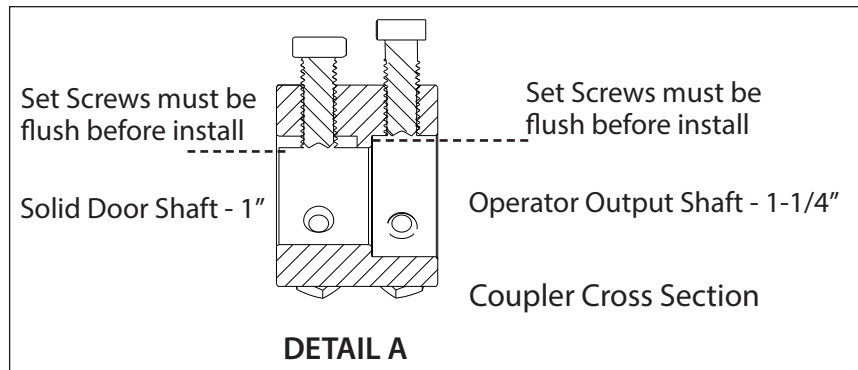

Slide Coupler onto Output Shaft until it stops

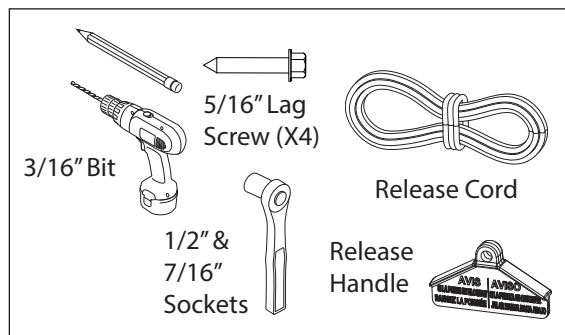
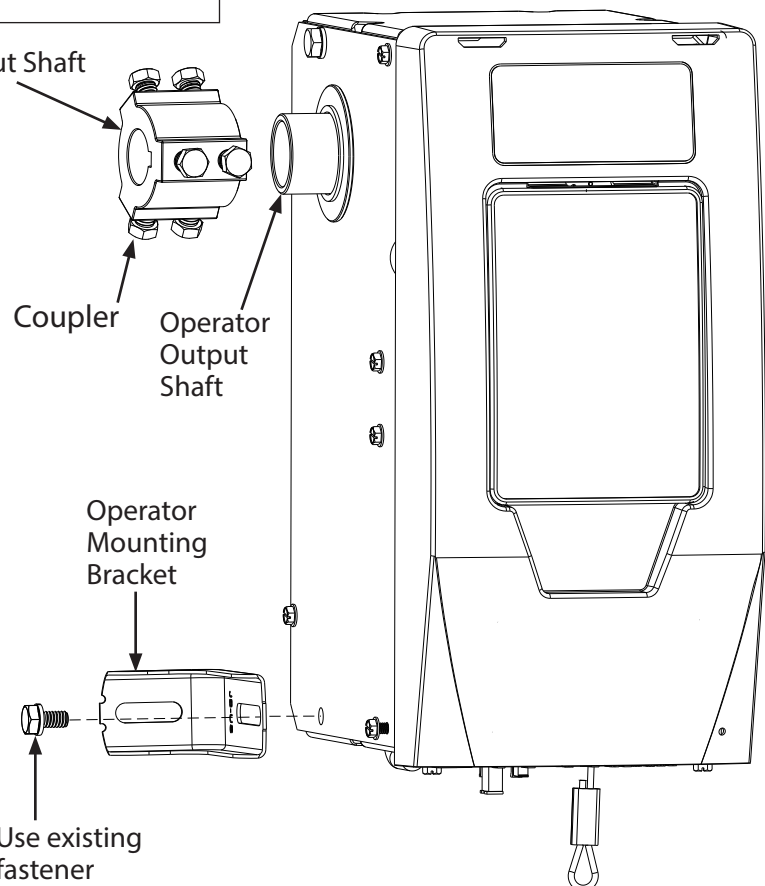

INSTALLING THE OPERATOR

4. Mount the operator to the door shaft.
 - If the door shaft is NOT keyed, slide operator assembly onto the door shaft.
 - If the door shaft IS keyed, insert the provided key into either keyway. Pull the emergency release cable at the bottom of the operator to allow free rotation of the output shaft to "clock" the keyways together.

NOTE: The mounting of this operator to the door shaft is designed so the door shaft will slide through the coupler and enter the hollow output shaft of the operator up to 3 -3/8" (there is a stop pin located in the center of the operator output shaft).

5. Tighten set screws onto the door shaft until contact is made.
6. Level and square the operator.
7. Mark the mounting bracket hole position, pre-drill a 3/16" pilot hole, install the lag screw and fully tighten.
8. Leave at least a 1/4" gap between the coupler and the door shaft bearing.
9. For Operator output shaft set screws, add 1 full turn in 1/4 turn increments.
For a solid door shaft, add 1/2 turn in 1/4 turn increments.
10. Tighten mounting bracket bolt to operator.

NOTE: Ensure all coupler set screws are secured prior to tightening mounting bracket bolt.

11. Pull the emergency release cable and manually operate the door to inspect for binding.
12. Tie the red emergency release cord to the cable loop and tie the release handle to the cord approximately 5' from the floor.

NOTE: Operator **MUST** be mounted to garage framing material. **DO NOT** install to particle board or drywall. The instructions above are provided using standard wood framing and bracing. Additional bracing may be required for this installation. Hardware for masonry or steel construction is not provided.

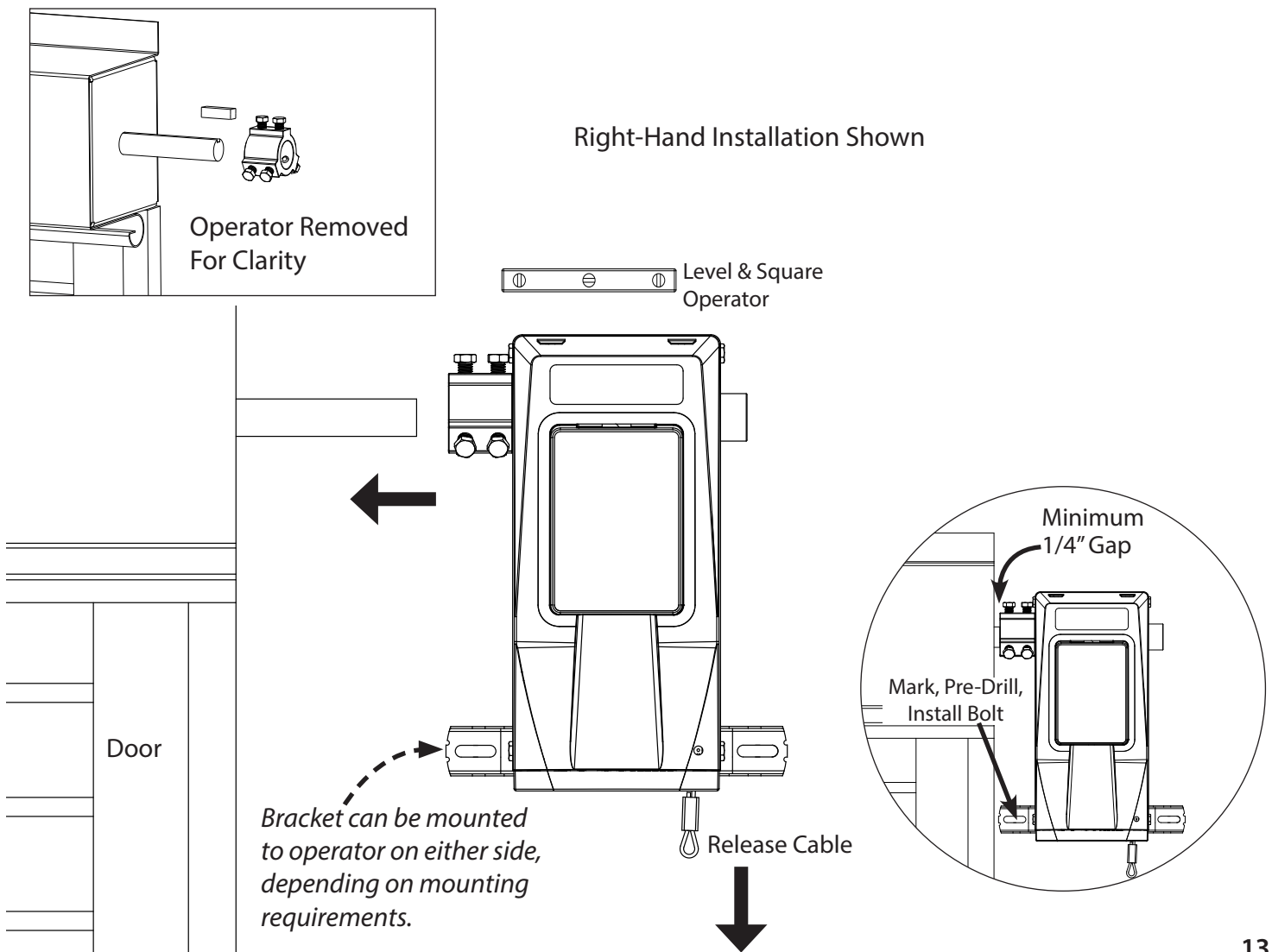

ALL Optional MONITORED SAFETY DEVICES LISTED ON PAGE 5 WIRE TO THE **STB** TERMINALS ON OPERATOR POWERHEAD. REFER TO INSTALLATION INSTRUCTIONS INCLUDED WITH DEVICE.

ONLY ONE MONITORED SAFETY DEVICE CAN BE INSTALLED TO THIS OPERATOR.

Install and Wire Safe-T-Beams® (STB) (Standard Equipment)

1. Position Safe-T-Beam® (STB) transmitter and receiver on each side of garage door 5"- 6" above floor. Face the lenses towards each other.
2. Mark bracket mounting holes; drill 3/32" pilot holes and secure with 1/4" x 1-1/4" lag screws (provided) into wood. If mounting into concrete or block, other fasteners are required and are not provided.
3. Route 2 lengths of supplied wire from powerhead, down to one sensor and along the header and down the side of the door to the other sensor. Secure the wire to the walls using the insulated staples.
4. On the powerhead: Remove 1/4" insulation from both sets of white and striped wire. Twist two white wires together. Using a small flat head screwdriver, press in the orange tab at one STB terminal and insert the wires. Twist the two striped wires together and insert into the other STB terminal.

NOTE: STB wires are not polarity sensitive.

5. At each sensor, remove 1/4" insulation from the white and striped wires and secure in each screw terminal.

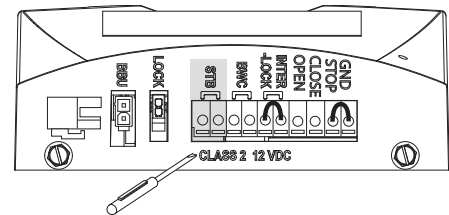
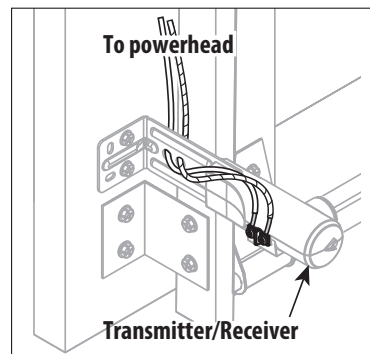
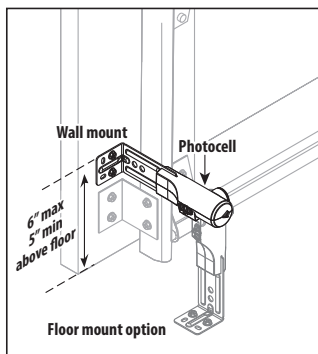

Install and Wire Safe-T-Beams® (STB) - W/COMM BRACKET (Optional)

1. Position heavy duty bracket and photocells per instructions provided with kit.
2. Attach both wires to operators STB terminals. Not polarity sensitive.

Install and Wire Photocell, Reflective (Optional)

1. Position reflective bracket and photocells per instructions provided with kit.
2. Attach both wires to operators STB terminals. Not polarity sensitive.

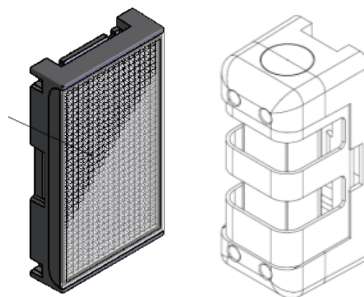

WIRE THE OPERATOR

Wire & Install NEMA 4X Photocells (Optional)

1. Fully close door.
2. Determine photocell location under the following considerations:
 - As near shutter opening as possible.
 - With an unobstructed path between photocells.
 - Extended from the wall so that door hardware will not obstruct beam.
 - Photocell must sit 5" to 6" above the floor.
3. Measure and mark hole locations for mounting brackets. Fig. 1
4. Drill 3/32" holes for mounting screws.
5. Mount brackets with provided screws. Fig. 1
6. Plug sensors into back of fixtures. Fig. 2.
 - They are labeled and must be put in their matching fixtures. Fig. 3
 - Once a sensor is inside a fixture they cannot be removed.
7. Press wire into channel cut into back of fixture. Fig. 2
8. Slide fixture onto mounting bracket and insert carriage bolt, washer, and wing nut loosely. Fig. 2
9. Adjust fixture on bracket as needed to align both sensors and tighten carriage bolt wing nuts.

Fig. 1

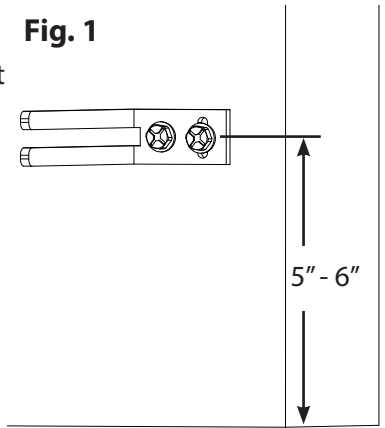

NOTE: Each photocell includes 50' of wire. If additional wire is required, attach to operator and connect to included wire with wire nuts.

10. Route wire from each photocell to operator. (Secure wire with staples or in conduit as required).
11. Install weather proof connector into enclosure.
12. Split wires and install one from each side into each of the STB inputs on operator (not polarity sensitive).

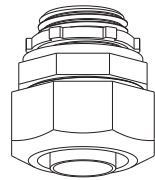
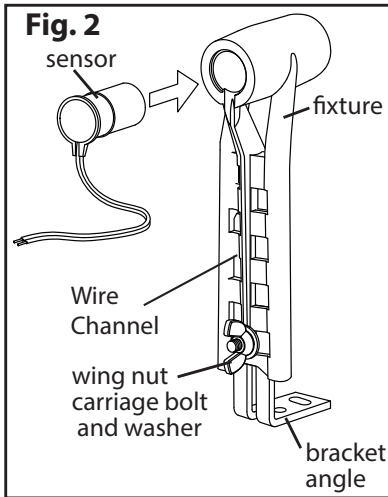

Use of waterproof type connector is recommended

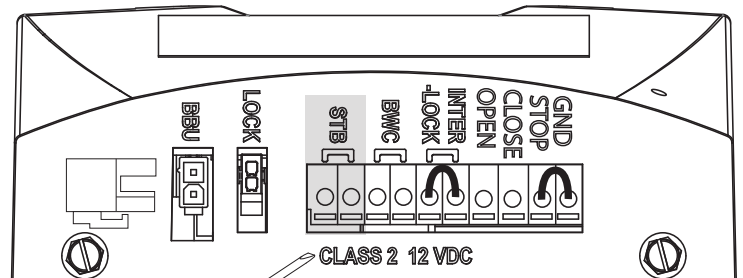
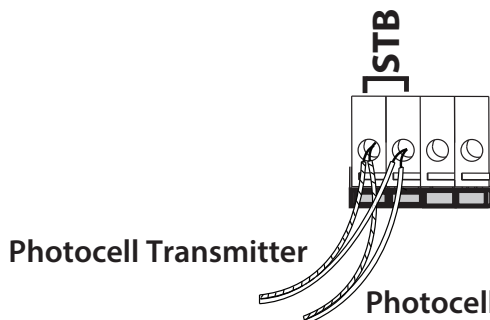
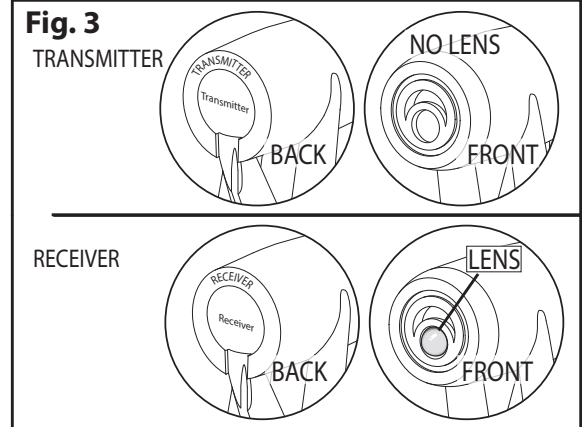

BOTTOM SIDE OF OPERATOR

WIRE THE OPERATOR

Monitored Light Curtain, Hardwired (Optional)

⚠ WARNING

Actuating the operator by using constant contact on the CLOSE button will override non-functioning external reversing devices, including sensing edges.

⚠ AVERTISSEMENT

L'activation de l'opérateur en utilisant un contact constant sur le bouton FERMER annulera les dispositifs d'inversions externes, y compris les systèmes de détection des bords.

1. Mount light curtain per instructions provided with kit.
2. Install white & green wires to STB terminals in operator.
3. Install red & black wires to transformer P/N 36328A.S

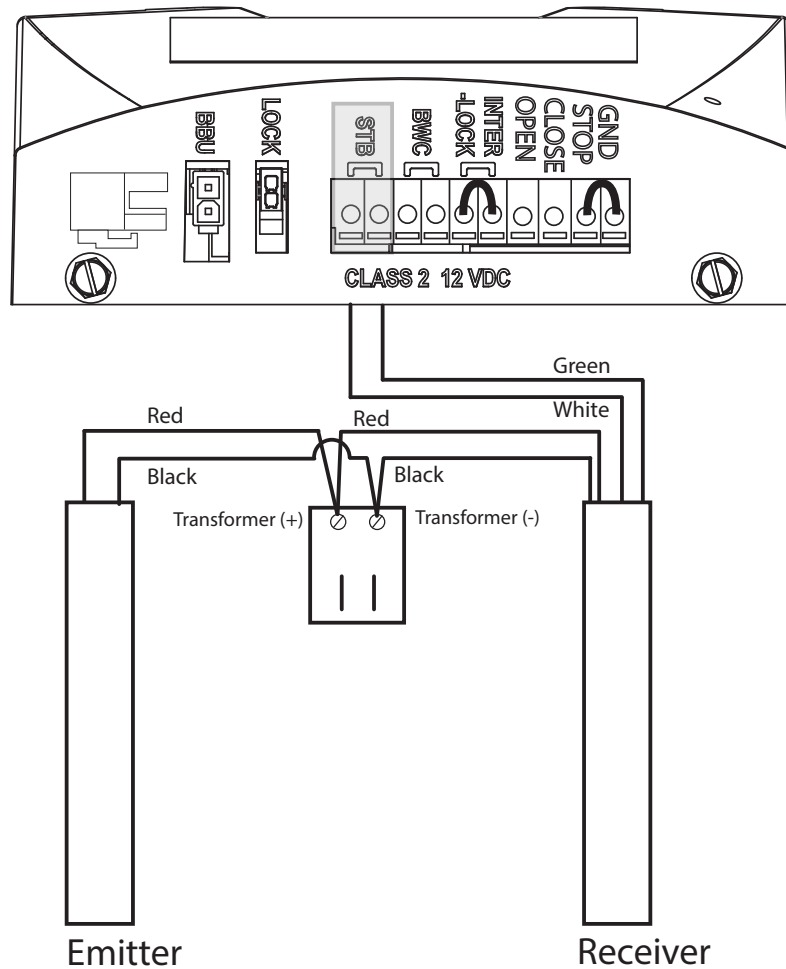

WIRE THE OPERATOR

Monitored Edges, Hardwired (Optional)

WARNING

Actuating the operator by using constant contact on the CLOSE button will override non-functioning external reversing devices, including sensing edges.

AVERTISSEMENT

L'activation de l'opérateur en utilisant un contact constant sur le bouton FERMER annulera les dispositifs d'inversions externes, y compris les systèmes de détection des bords.

MillerEdge® "DC" Series & ASO Monitored Sensing Edge Installation with Interface Module

Right-hand installation shown, left-hand installation mirrored.

1. Mount junction box to wall one half the door height plus 12" from floor.
2. Install hard-wiring from operator and coil cord to junction box and secure with conduit clamps.
3. Connect hard-wiring from operator to coil cord with wire nuts and install junction box cover plate. These are not polarity sensitive.
4. Install wires to STB terminals in operator.
5. Attach coil cord to monitored edge interface module in junction box as shown and secure with conduit clamps.
6. Install wires from monitored edge to interface module as shown below.
7. Install cover plate.
8. Install wires to STB terminals in operator.

NOTE: DO NOT use take up reels with monitored edge systems.

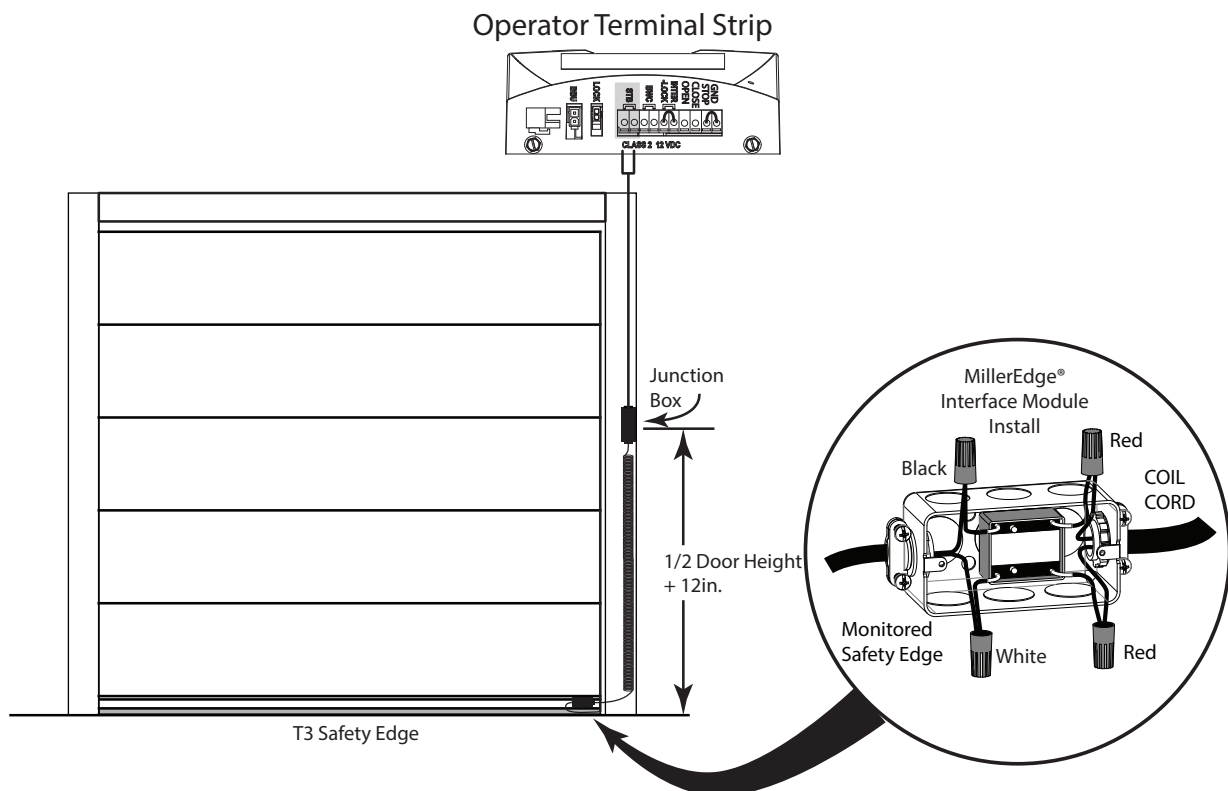

WIRE THE OPERATOR

Monitored Edges, Wireless (Optional)

WARNING

Actuating the operator by using constant contact on the CLOSE button will override non-functioning external reversing devices, including sensing edges.

! AVERTISSEMENT

L'activation de l'opérateur en utilisant un contact constant sur le bouton FERMER annulera les dispositifs d'inversions externes, y compris les systèmes de détection des bords.

MillerEdge® Wireless Monitored Sensing Edge Installation

CAUTION: THIS PROCEDURE MUST BE PERFORMED WITH THE DOOR IN THE CLOSED POSITION ONLY.

Door Installation - Wireless Edge System:

1. Move door to the fully closed position.
2. Remove power from the unit. Use proper lock-out/tag-out procedures. (Refer to OSHA Standard 1910.147).
3. Mount the RBand receiver near the operator in a dry area.
4. Route wire from RBand receiver to operator and attach as shown below.
5. Mount RBand RB-TX10 transmitter, GT3C converter (when required), transformer (when required) and edge sensor as shown in the manufacturers instructions.
6. Wire safety edge, GT3C converter (when required) per application using table above.
7. Insert batteries into the RB-TX10 transmitter and GT3C converter (when required).
8. Apply power to operator.
9. Follow RBand instruction sheet to learn the RB-P-K10 receiver to the RB-TX10 transmitter.
10. Program operator ODC-STB to the ON status (see installation manual).
11. Run full operational and safety function test.

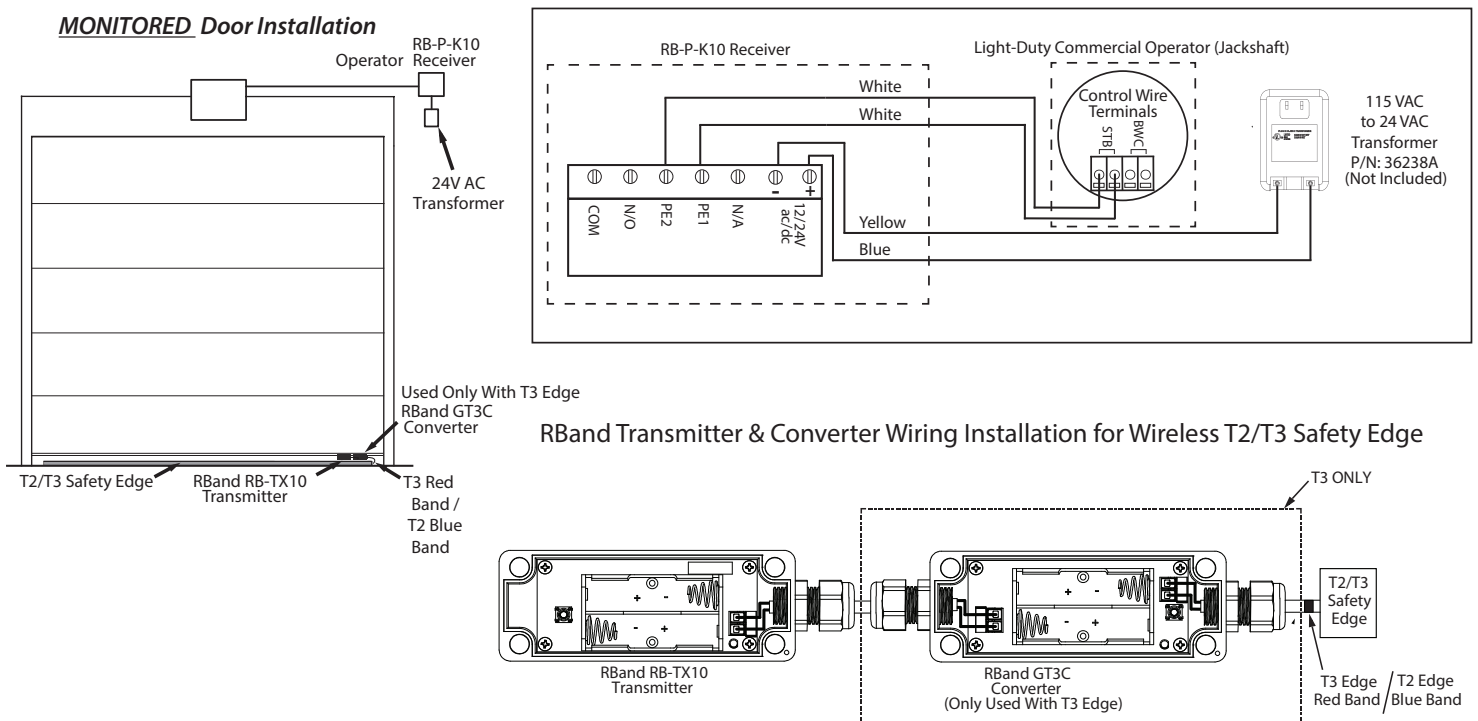

WIRE THE OPERATOR

Wiring Control Stations

1. For a single open/close/stop installation, make connections as shown in Fig. 1.
2. For single button accessory controls, make connections as shown in Fig. 2.
3. For a multiple open/close/stop installations, make connections as shown in Fig. 3.
4. Install WARNING placard next to control station. Fig. 4

NOTE: Do not remove jumper between STOP and GND terminals unless using an OPEN/CLOSE/STOP pushbutton.

NOTE: Jumper between STOP and GND terminals must be removed.

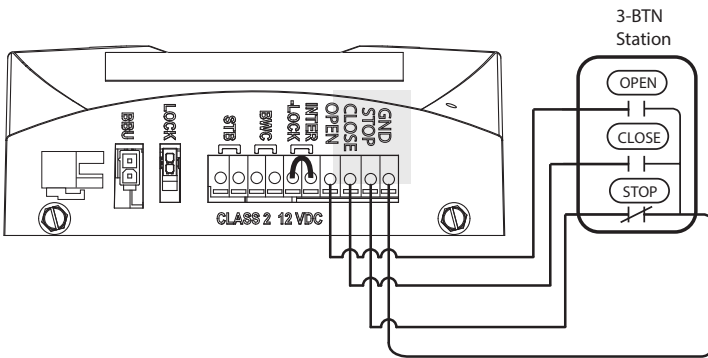

Fig. 1

Light Fixture Control & Stop Button Functionality:

- Pressing stop during operation will halt the door immediately.
- Pressing stop while the door is at the up limit or mid-stop with time-to-close (TTC) turned on disables TTC until the door reaches either of these limits again.
- If an optional light fixture is paired, pressing stop with the door idle allows for the light to be toggled on and off.
- Pressing stop to toggle the light overrides the default 4 minute auto-shutoff light timer, allowing for the light to remain on indefinitely or until the next door movement.

NOTE: Jumper between STOP and GND terminals must be removed.

Momentary Contact Switches

NOTE: Jumper between STOP and GND terminals must NOT be removed unless STOP button is installed.

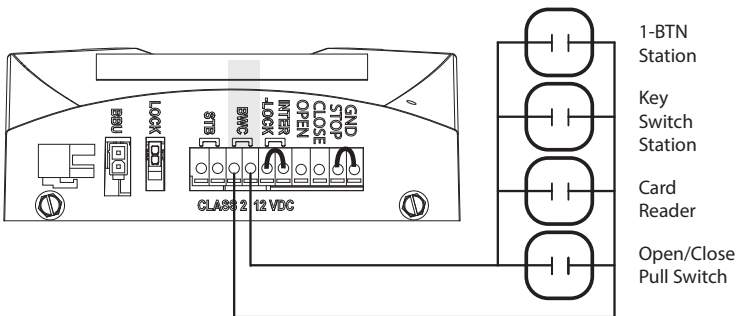

Fig. 2

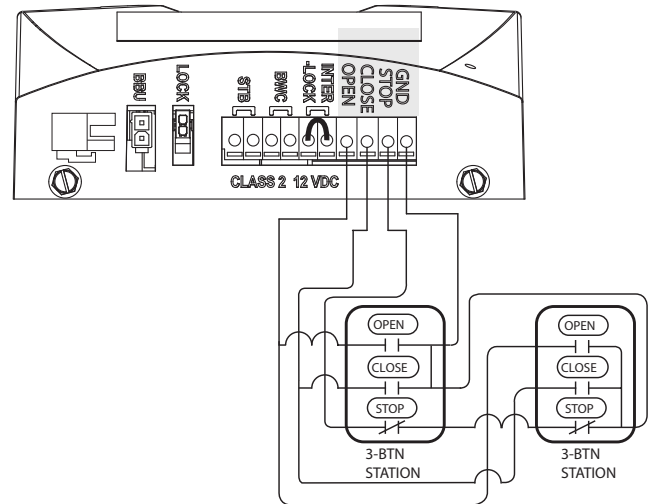

Fig. 3



Entrapment Warning Placard

Fig. 4

FINISHING THE INSTALLATION

Install Bluetooth® Light Fixture (Optional)

1. Determine mounting location within 30' of operator.
2. Pre-drill two 3/32" holes for mounting screws, or two 3/16" if using drywall anchors (supplied) if needed. 7-1/2" apart.
3. Install supplied screws leaving an 1/8" gap for mounting.
4. Route power cord through cutouts in flange and plug light into a standard 115 VAC outlet. Secure excess wire under light housing.
5. Align light fixture mounting holes with screws and turn light assembly to lock into place.

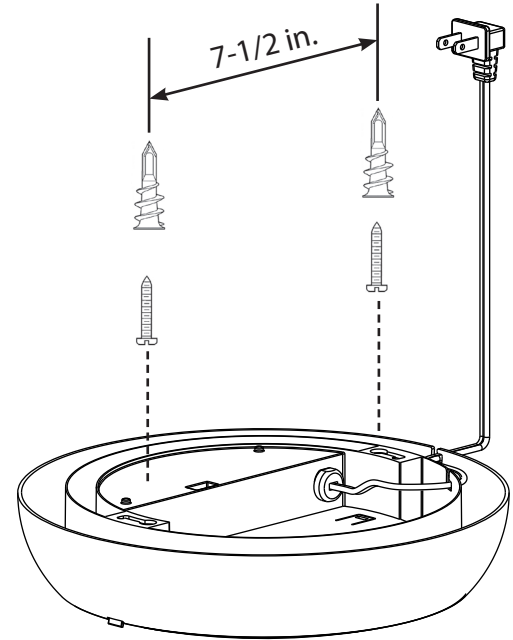

Light will automatically pair when operator and light fixture are powered up.

1. Light fixture will short flash and beep when powered up.
2. Light fixture will long flash when it pairs with operator.
3. Light fixture is now paired to operator and will operate as normal.

⚠ IMPORTANT NOTICE ⚠

This light kit must be used with the optional Aladdin Connect® application. See Page 36.

Install Wireless Wall Console (Optional)

1. Determine mounting location for wireless wall console.
2. Mount console no less than 5' above floor to prevent small children from activating operator.
3. Pre-drill 3/32" holes for mounting screws, or 3/16" if using drywall anchors (supplied) if needed.
4. Install bottom screw leaving a 1/8" gap.
5. Slide console onto screw and down slightly to lock in place.
6. Remove upper battery door and remove protective tab and batteries.
7. Install top screw to secure console to the wall.
8. Install batteries and battery door.
9. Install warning decal in the same area as wireless wall console.

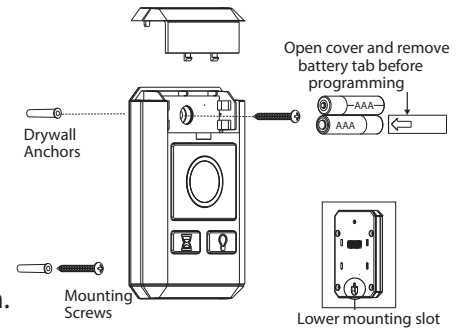

Program Wireless Wall Console

1. Remove the battery's protective film from the remote by pulling straight down.
2. Press and hold the SET/PRGM button on the operator for 2-5 seconds.
 - The round LED will turn blue. Release button.
 - The long LED will then flash purple.
3. Slowly press and release the DOOR button on the console two times.
4. Both operator LEDs will flash and turn off indicating the console has been programmed.
5. Press the console DOOR button again.
6. The operator should run.

Wall Console Operation

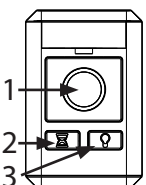

1. DOOR Button - Runs garage door operator.
2. DELAY Button - Adds a 10+ second delay for door operation. Press the delay button and door will automatically operate after set delay. Can be activated up to 3 times for a 10, 20 or 30 second delay.
3. LIGHT Button - Overrides the automatic timed light function of the garage door operator.

FINISHING THE INSTALLATION

Install and Wire Basic Wall Console (Hardwired) (Optional)

1. Route supplied wire from powerhead to the desired location for the hardwired wall control. Secure wire with insulated staples.
2. On the powerhead: Remove 1/4" insulation from white and striped wire. Using a small flat head screwdriver, press in the orange tab and insert the white wire into BWC WHITE terminal and the striped wire into BWC BLACK terminal.
3. At the wall console end of the wire, remove 1/4" insulation from the white and striped wires and secure the white wire to the "W" terminal and the striped wire to the "B/W" terminal as shown.
4. Mark the wall console mounting holes, drill 3/32" pilot holes and mount with #6 x 1-1/4" screws. If mounting to drywall, anchors will be required (not provided).
5. Insert jumper between STOP and GND terminals unless an OPEN/CLOSE/STOP pushbutton is also used.

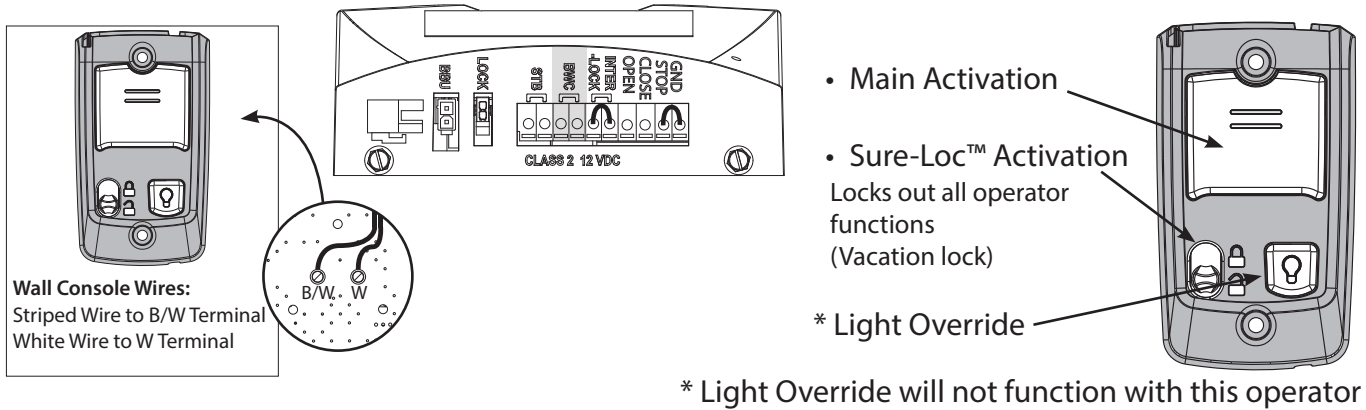

Install and Wire N/C Interlock (Optional)

1. Do not remove factory installed interlock jumper wire unless installing an interlock. This jumper is required for proper operation.
2. Use of any commercially available normally closed (N/C) dry contact interlocks can be used with this operator. Using a small flat head screwdriver, press in the orange tabs at INTER-LOCK terminals and remove factory installed jumper wire and insert the interlock wires.

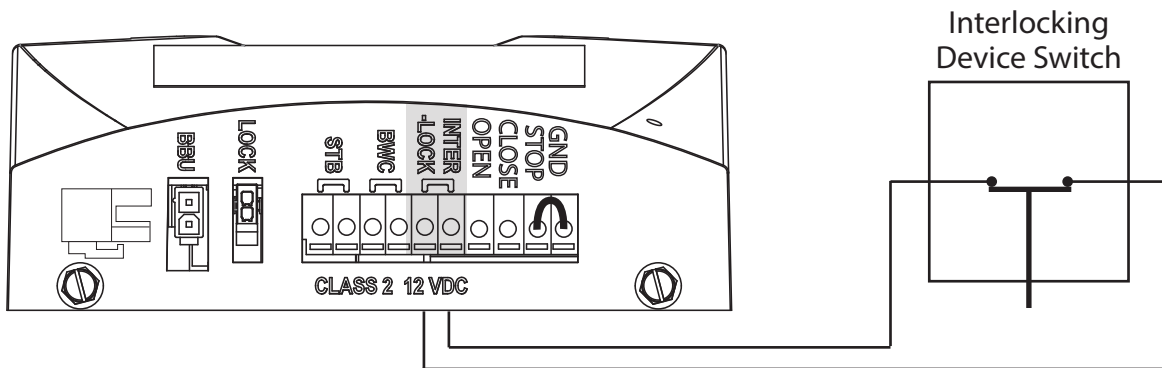

Install Bottom Cover Onto Operator

(Omit this step if installing battery backup)

1. Remove two screws on the bottom of operator.
2. Route wires to the rear of operator to align with slot in rear of cover.
3. Install cover with screws that were removed in step 1.

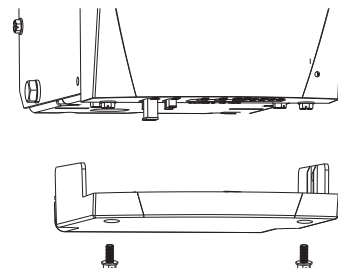

FINISHING THE INSTALLATION

Install Battery Backup (BBU) (Optional)

1. Unplug power from operator.
2. Remove two screws securing bottom cover to operator head and remove cover.
3. Hold battery backup assembly at a 45 deg. angle near operator and route wires to back of operator between battery mounting tabs.
4. Insert rear tabs into slots on bottom of operator.
5. Plug connector of battery backup into the BBU connection on bottom of operator. Ensure connector is inserted in correct direction (SEE INSET).
6. Align battery backup to bottom of operator and secure with two screws removed in step 2.

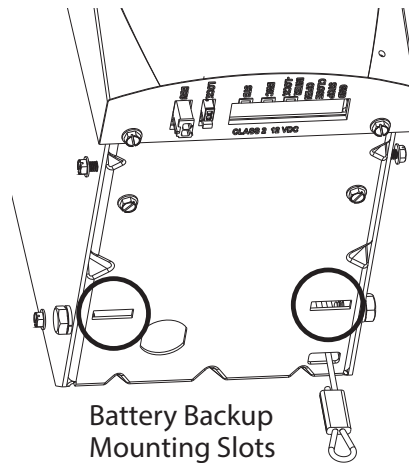
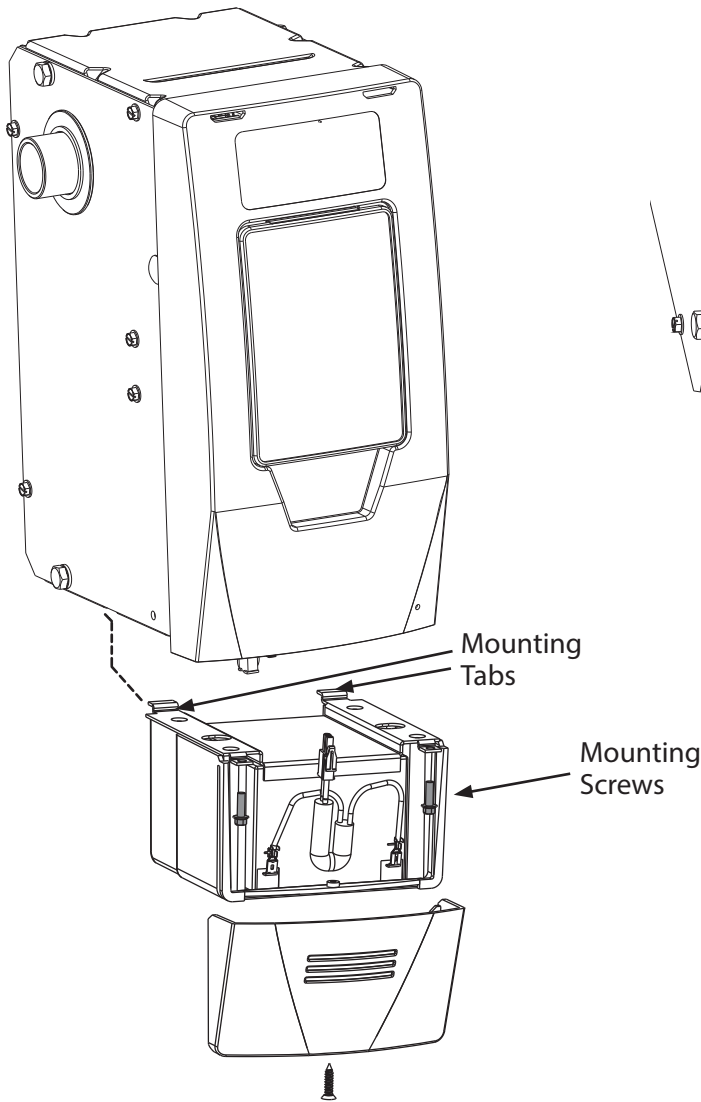

CAUTION TO PREVENT POSSIBLE SERIOUS INJURY or DEATH from electrocution AND REDUCE RISK of FIRE
 — Disconnect ALL electric power sources and battery power BEFORE performing ANY service or maintenance.
 Install only in DRY locations - NOT INTENDED FOR OUTDOOR USE.
 Use only 12V, 5AH, SLA replacement battery
 (P/N 111658.0002.S).

ATTENTION POUR ÉVITER LES BLESSURES GRAVES VOIRE MORTELLE PAR ÉLECTROCUTION POUR RÉDUIRE ES LES RISQUES D'INCENDIE
 — Débrancher toutes les sources d'alimentation électriques et la pile avant d'effectuer des opérations de réparation ou d'entretien.
 Installer uniquement dans des endroits secs — NE DOIT PAS ÊTRE UTILISÉ À L'EXTÉRIEUR.
 Utiliser uniquement une pile de remplacement de 12V, 5AH, SLA (réf. 111658.0002.S).

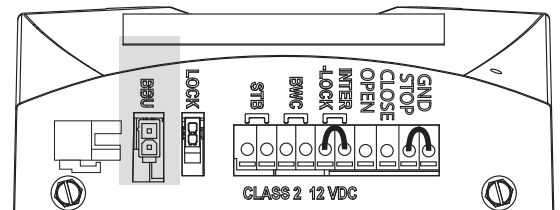
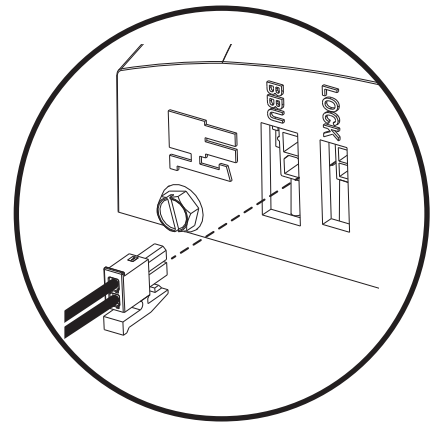

AC power must be present to set limits. DO NOT attempt to set limits or any other programming steps from battery power only.

Testing the Battery Backup

NOTE: It is recommended that the battery backup be allowed to charge for 24 to 48 hours prior to testing. Initially, the operator may not operate from the battery backup mode if battery is not fully charged.

1. Run the operator using the wall control or remote to ensure it is working properly.
2. Turn off power to operator by unplugging from outlet or turning off breaker.
3. Press wall control or remote control. Operator will run at a slower speed than normal.

NOTE: See troubleshooting guide in this manual if any of the steps above fail.

4. After successful test, reconnect powerhead to power source.

FINISHING THE INSTALLATION

Apply power to operator



CAUTION

DO NOT run operator until travel limits have been set to avoid damage to unit.



CAUTION

NE PAS faire fonctionner l'ouvre-porte au-delà des limites de parcours pour ne pas endommager l'unité.



WARNING

Operator is equipped with grounded electrical plug for your protection, and only fits grounded electrical outlets. **DO NOT** alter plug in any way! If you have no grounded outlets, have one installed by a licensed electrician. Operator must be properly grounded to prevent personal injury and equipment damage. **NEVER USE AN EXTENSION CORD!** Check local building codes for any requirement that you must have a permanent hard-wired connection.



AVERTISSEMENT

L'opérateur, qui est équipé d'une prise électrique mise à la terre pour votre protection est compatible uniquement avec des prises électriques mises à la terre. **NE PAS** modifier la fiche d'une quelconque manière. Si vous n'avez pas de prises mises à la terre, faites-en installer par un électricien agréé. L'opérateur doit être correctement mis à la terre pour éviter les blessures corporelles et des dommages matériels. **NE JAMAIS UTILISER DE RALLONGE!** Vérifiez les codes locaux des bâtiments pour connexions câblées permanente. Les connexions câblées permanentes doivent être effectuées par un électricien agréé qui se servira d'outils appropriés et respectera les consignes.

FOR GROUNDED OUTLET CONNECTION:

Plug in the power cord to standard 115 VAC grounded outlet. Coil excess cord and tape or twist tie it to top of powerhead.

DO NOT USE EXTENSION CORDS TO POWER THIS OPERATOR. Extended power input kits are available if a grounded outlet is not available within 5' of operator.

NOTE: Before programming the operator, check to make sure there are no objects in the garage door opening. DO NOT allow persons to enter the area of the door while programming and operating.

The following steps list the order of programming the operator's functional settings as well as installation of any accessories that were included with the operator or purchased separately. These steps should be performed in order.

1. Adjust operator speed for door type
2. Down travel limit
3. Up travel limit
4. Force control
5. Remote control programming
6. Light fixture programming (if applicable)
7. Wireless wall console programming (if applicable)
8. Program wireless keypad (if applicable)
9. Program built in vehicle remote (if applicable)
10. Program the integrated Wi-Fi Genie Aladdin Connect® (if applicable)

Programming Button Layout

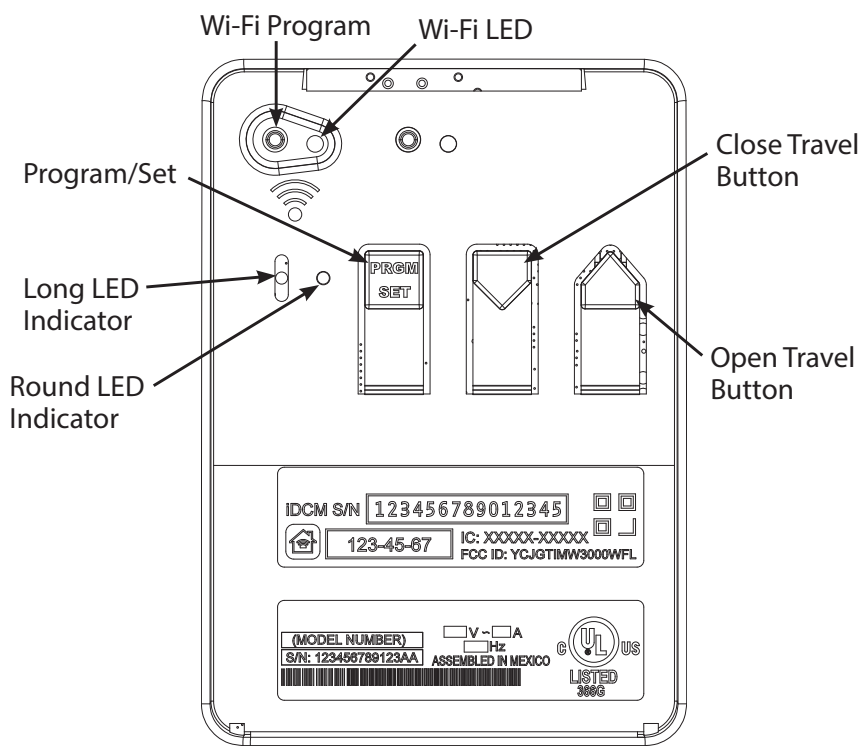

NOTE: Each programming step has a 30 second time limit for completion after the function is initiated. After 30 seconds, both LEDs will illuminate BLUE indicating time has expired and the step must be restarted. Restart the step as many times as necessary to complete the programming.

Remote controls, wireless keypads, wireless wall controls, and bluetooth control programming will reset after 60 seconds.

ADJUSTING FOR DOOR TYPE

Door Type Settings:

Door type mode is set at the factory to Mode 1.

Door type Mode 1 will be automatically selected for any door that requires 3.5 turns or less of the operator output shaft between open limit and closed limit.

Door type Mode 2, 3, and 4 are for direct coupled applications to live shaft sheet doors. Mode 2 will run the slowest, and Mode 4 will run the fastest. Start with Mode 2 and increase to Mode 3 and 4, based on acceptable door operation. Limits must be set to greater than 3.5 turns apart.

Door type Mode 5, 6, and 7 are for chain coupled applications to dead shaft sheet doors. Mode 5 will run the slowest, and Mode 7 will run the fastest. Start with Mode 5 and increase to Mode 6 and 7, based on acceptable door operation. Limits must be set to greater than 3.5 turns apart.

! IMPORTANT NOTICE !

IF DOOR TYPE SELECTION SETTING IS ALTERED, ALL STEPS ON PAGE 29 MUST BE PERFORMED TO SET THE FORCE PROFILE FOR PROPER DOOR OPERATION.

To Change Door Selection:

1. Press and hold the SET/PRGM button on the operator until both LEDs turn blue then release.
2. Press the UP button twice.
3. Press PRGM button once.
4. The current setting will now be displayed. (see chart).
5. Press either UP or DOWN buttons to adjust setting (see chart)
6. Press PGRM button once to lock in the selection. LEDs turn blue, then off.
7. Operator is now ready to set limits.

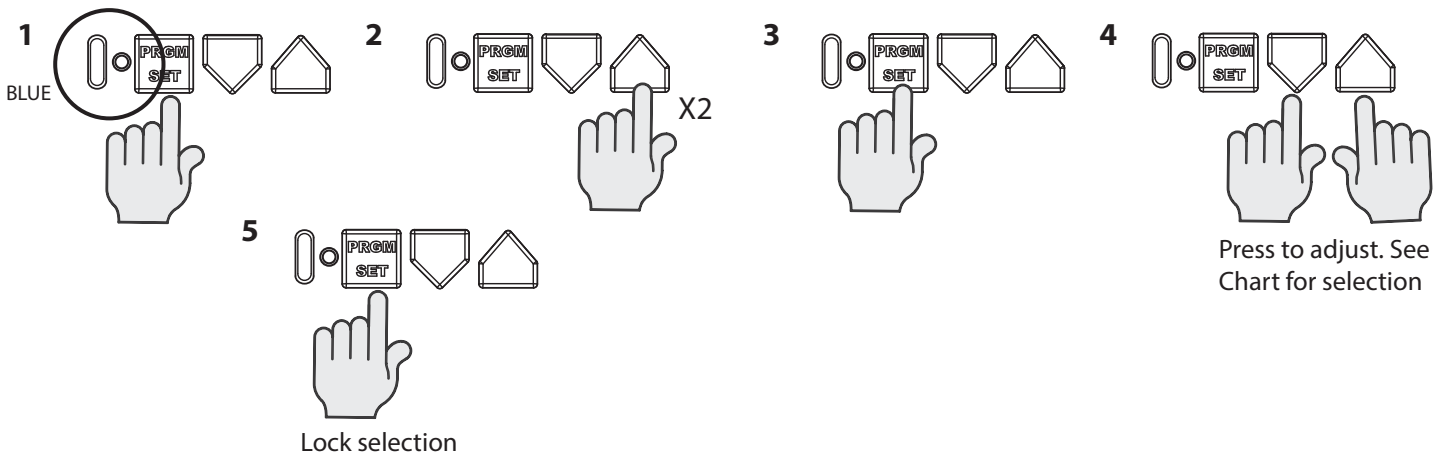

DOOR TYPE CHART			
Mode	Door Type	LED UI Color Patterns	
		Long LED	Round LED
1	(Less than 3.5 Turns Between Limits) Default	OFF	BLUE
2	Live Shaft Direct Couple (low speed)	BLUE	OFF
3	Live Shaft Direct Couple (medium speed)	BLUE	BLUE
4	Live Shaft Direct Couple (high speed)	OFF	PURPLE
5	Dead Shaft Chain Couple (low speed)	PURPLE	OFF
6	Dead Shaft Chain Couple (medium speed)	OFF	RED
7	Dead Shaft Chain Couple (high speed)	RED	OFF

ADJUSTING FOR DOOR TYPE

		Commercial Shutter Doors						
		HEIGHT (FT)						
		6	7	8	9	10	11	12
WIDTH (FT)	6	2,3,4	2,3,4	2,3,4	2,3	2,3	2	2
	7	2,3,4	2,3,4	2,3,4	2,3	2,3	2	2
	8	2,3,4	2,3,4	2,3,4	2,3	2,3	2	2
	9	2,3,4	2,3,4	2,3,4	2,3	2,3	2	2
	10	2,3,4	2,3,4	2,3,4	2,3	2,3	2	2
	11	2,3,4	2,3,4	2,3,4	2,3	2,3	2	2
	12	2,3,4	2,3,4	2,3,4	2,3	2,3		
	13	2,3,4	2,3,4	2,3,4	2,3			
	14	2,3,4	2,3,4	2,3,4	2,3			
	15	2,3,4	2,3,4	2,3,4				
	16	2,3,4	2,3,4	2,3,4				

Mode Compatibility Legend			
MODE 2			
MODE 3			
MODE 4			
Not Compatible			

PROGRAMMING THE DOWN LIMIT

⚠ WARNING

- Make sure doorway is in full view and clear of obstacles and people to avoid injury or property damage.
- DO NOT operate this unit from the wall control before LIMITS are set. Severe damage to the operator could occur.
- DO NOT set limits with Battery Backup attached. AC power MUST be connected to the operator while setting limits for proper operation.

⚠ NOTE: Door MUST be engaged to the operator prior to programming. Door should rest somewhere between full open and closed. **DO NOT START WITH DOOR FULLY OPEN OR CLOSED.**

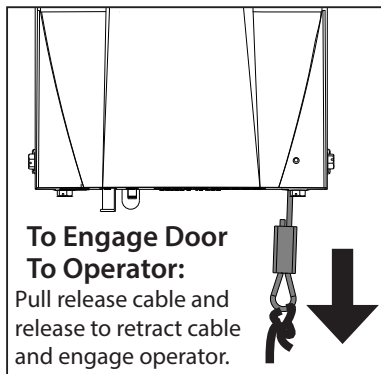

Programming DOWN Limit:

1. Press and hold the DOWN arrow button on the operator for 2-5 seconds.
 - The long LED will turn blue. Release button.
 - The long LED will then flash blue.
2. Press and hold the DOWN arrow button until door is fully closed.

NOTE: Door should rest on the floor until the weather strip is compressed enough to seal along the width of the door. Damaged doors or uneven floors may not seal properly. Repair these conditions to achieve a proper seal. DO NOT compress seal so much that the door will bend or buckle.

3. Use both UP and DOWN buttons to adjust close travel as necessary until door is at the desired down limit position.
4. Press and release the SET/PRGM button
5. Both LEDs will flash blue, then go out.
6. The down limit is now programmed.

⚠ AVERTISSEMENT

- S'assurer que le passage de la porte est visible et dégagé, à savoir sans obstacles ni personne afin d'éviter toute blessure potentielle ou dommage matériel.
- NE PAS utiliser cette unité avec la console murale avant d'avoir réglé les LIMITES. L'ouvre-porte pourrait subir de sérieux dommages.
- NE PAS fixer de limites en mode batterie de secours. L'alimentation CA DOIT être branchée sur l'ouvre-porte, pendant le réglage des limites, pour assurer un bon fonctionnement.

1-2. Enter Programming Mode

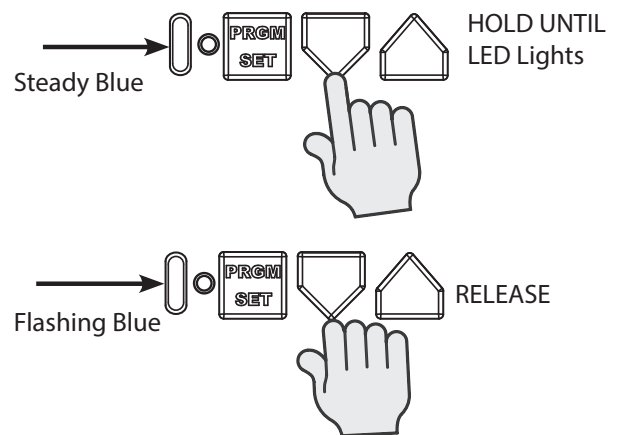

3. Adjust Door Position

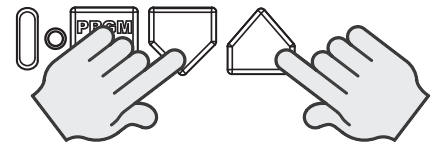

4. Lock Programming

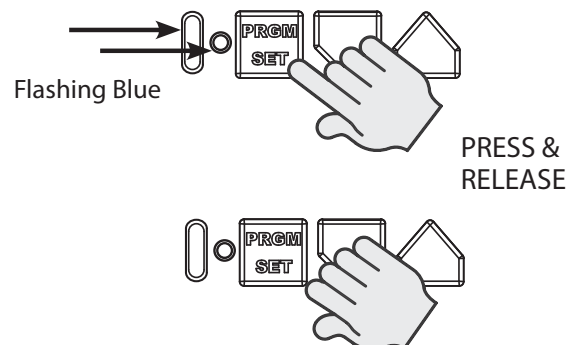

⚠ IMPORTANT NOTICE ⚠

IF LIMIT SETTING IS ALTERED, ALL STEPS ON PAGE 29 MUST BE PERFORMED TO SET THE FORCE PROFILE FOR PROPER DOOR OPERATION.

PROGRAMMING THE UP LIMIT

Programming UP Limit:

1. Press and hold the UP arrow button on the operator for 2-5 seconds.
 - The long LED will turn blue. Release button.
 - The round LED will then flash blue.
2. Press and hold the UP arrow button until door is fully open.
3. Use both UP and DOWN buttons to adjust open travel as necessary until the door is at the desired up limit position.
4. Press and release the SET/PRGM button
5. Both LEDs will flash blue then go out.
6. The up limit is now programmed.

1-2. Enter Programming Mode

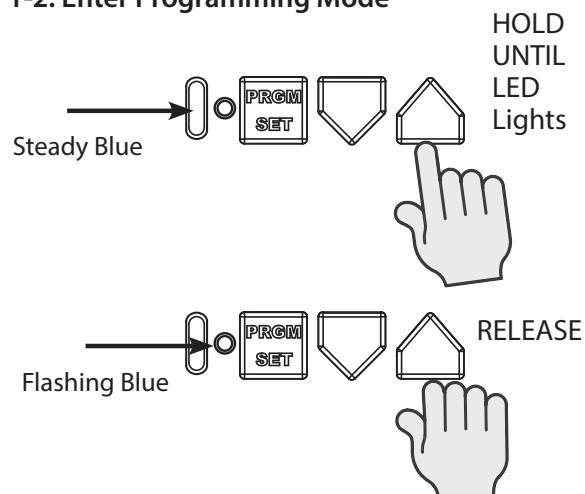

3. Adjust Door Position

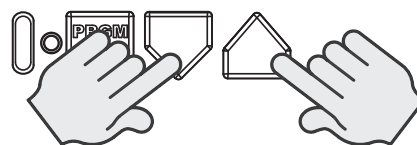

4. Lock Programming

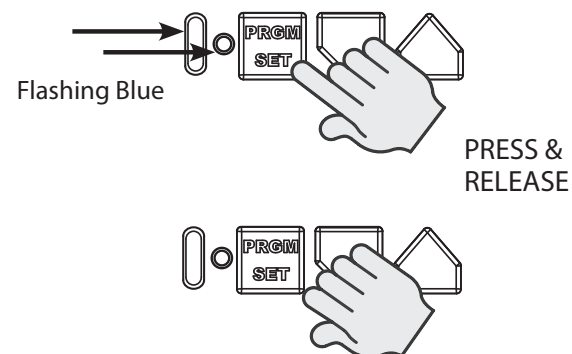

⚠ IMPORTANT NOTICE ⚠

IF LIMIT SETTING IS ALTERED, ALL STEPS ON PAGE 29 MUST BE PERFORMED TO SET THE FORCE PROFILE FOR PROPER DOOR OPERATION.

PROGRAMMING FORCE PROFILE

⚠ IMPORTANT NOTICE ⚠

THIS STEP MUST BE PERFORMED FOR PROPER OPERATION!

- *Run operator 2 full cycles up and down to set new operator profile.*

⚠ WARNING

- **TO AVOID INJURY OR DAMAGE**
- **NEVER** adjust the force settings to adjust for damage, including an unbalanced door, binding door track or broken spring.

⚠ AVERTISSEMENT

- Pour éviter les blessures ou des dommages
- **NE JAMAIS** régler la force pour compenser des dommages, y compris une porte mal équilibrée, un rail de porte coinçant ou des ressorts cassés.

Setting Force Profile

1. Press and release the wall control button and allow the garage door to travel and stop at the DOWN limit.
2. Press and release the wall control button and allow the garage door to travel and stop at the UP limit.
3. Repeat steps 1 and 2 to complete this setting.

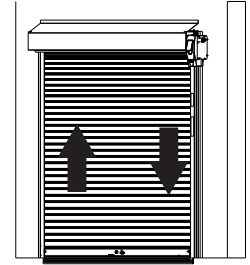
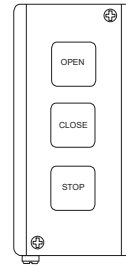

Force Control Adjustments

Force settings are programmed from the factory to remain within safe parameters. These should not require adjustments. However, certain circumstances may require adjustment.

Refer to page 33 to adjust the force settings.

PROGRAMMING REMOTE CONTROLS

NOTE: The following instructions are for remote control transmitters purchased separately or if remote(s) require re-programming.

NOTE: Each programming step has a 60 second time limit for completion after the function is initiated. After 60 seconds, two LEDs will illuminate blue indicating time has expired and the step must be re-started. Restart the step as many times as necessary to complete the programming.

1. Remove the battery's protective film from the remote by pulling straight out if tab is present.
2. Press and hold the SET/PRGM button on the operator for 2-5 seconds.
 - The round LED will turn blue. Release button.
 - The long LED will then flash purple.
3. Stand at least 5 feet away from operator and slowly press and release the desired button on the remote two times.
4. Both operator LEDs will flash and turn off indicating the remote has been programmed.
5. Press the desired remote button again.
6. The operator should run.

To program the same remote for other garage door operators, repeat the steps above using one of the other remaining remote buttons.

REPEAT STEPS 1 TO 4 FOR EACH OPERATOR AND REMOTE

NOTE: It is possible to press the remote button too quickly or lightly. If the LEDs do not go off, press the remote button several more times to achieve confirmation.

BASIC PROGRAMMING IS COMPLETE AND YOUR GARAGE DOOR OPERATOR IS READY TO USE.

See page 34 of this manual to erase remote devices from memory.

1. Enter Programming Mode

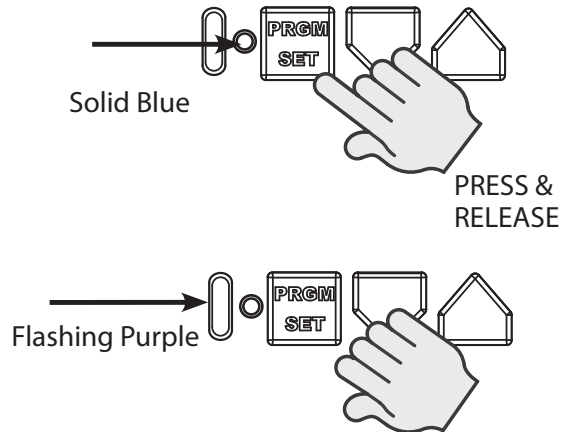

2. Press Remote Button Twice

1-2-3 or 4 Button Transmitters

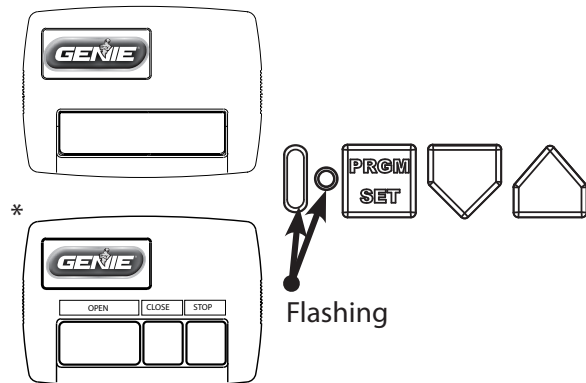

3. Test Remote

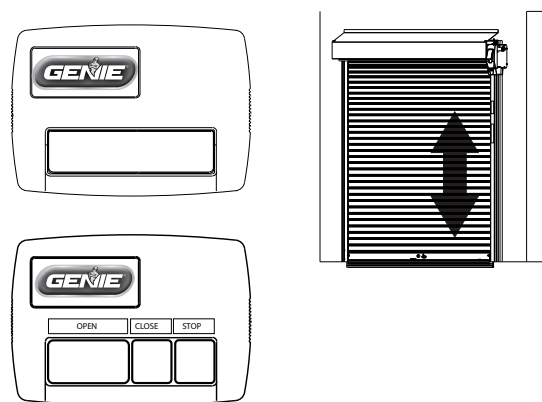

PROGRAMMING MID-STOP (Optional)

NOTE: The mid-stop can be set to allow the door to come to a stop somewhere between the open and close limits. This must be set after the open and close limits have been set and a force profile has been generated.

1. Starting from either limit, press and hold the UP arrow button until the long LED and round LED start to alternate flashing blue, then release. The operator will display a flashing blue round LED.
2. Using the UP and/or DOWN arrow buttons, move the door to any position between the open and close limits.
3. Once the door is in the preferred mid-stop location, press the SET/PGRM button. The operator will flash blue on both LEDs three times saving the mid-stop location.

NOTE: The mid-stop will now be the first position the door will stop when trying to open the door. If the door needs to be raised to the open limit, press OPEN on any open/close/stop control station or remote to move the door to the open limit. (It is not possible to reach the open limit with a mid-stop and a 1-button control.)

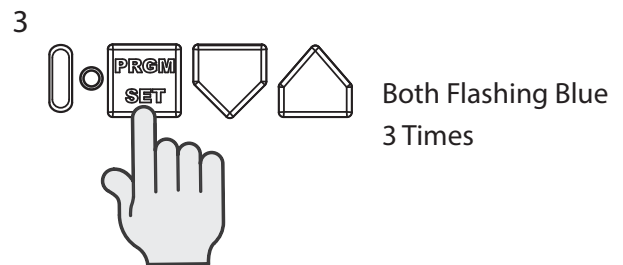
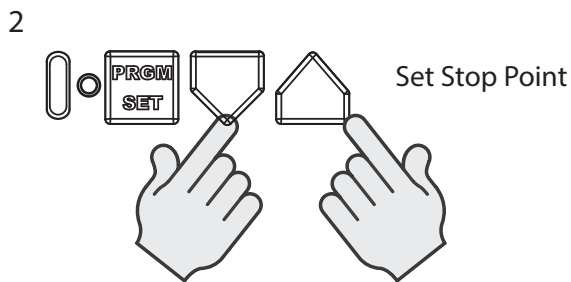
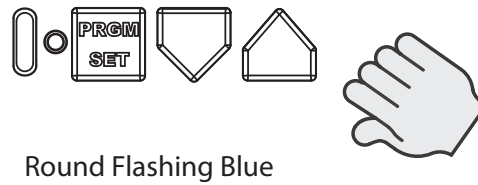
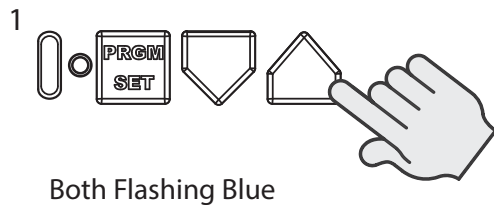

PROGRAMMING TIME-TO-CLOSE (Optional)

NOTE: Time-to-close (TTC) is used to close the door after it has been raised to either the mid-stop or the open limit after a specific amount of time.

NOTE: A monitored safety device must be connected to the operator STB input and functioning for the time-to-close feature to activate door closure.

1. Press and hold both UP and DOWN arrow buttons until the round LED is yellow, then release.
2. Using the UP and DOWN arrow buttons and the chart below, select the corresponding LED pattern for the preferred TTC length. (see chart below).
3. Press and release the SET/PGRM button to confirm the TTC setting. The operator will briefly flash both LEDs as blue to show the TTC has been set before returning to normal operation.

NOTE: TTC will not work if the door operation was halted or reversed due to a door obstruction detection, force detection, or use of a stop button.

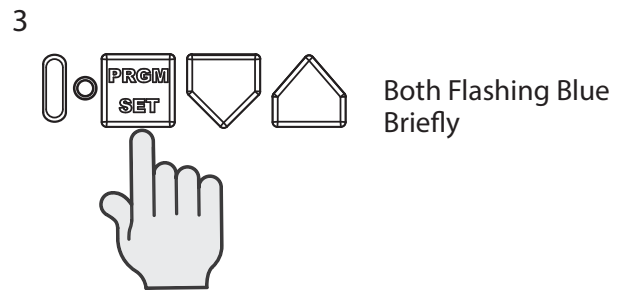
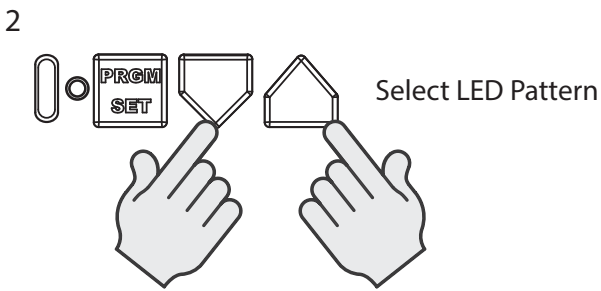
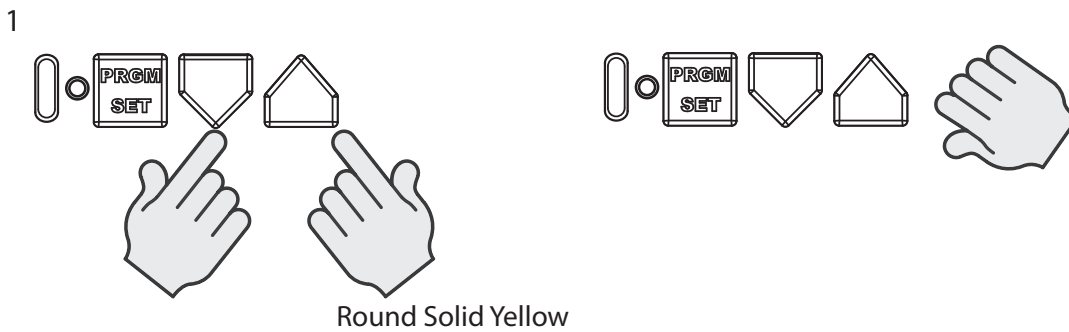

Time-To-Close Table		
TTC Time	Long LED	Round LED
OFF	RED	RED
15 s	OFF	BLUE
30 s	BLUE	OFF
1 min	BLUE	BLUE
1 min 30 s	OFF	PURPLE
2 min	PURPLE	OFF
3 min	PURPLE	PURPLE
4 min	OFF	RED
5 min	RED	OFF

5 SPECIAL INSTALLATION INFORMATION

Changing Force Settings

⚠ WARNING

TO AVOID INJURY OR DAMAGE

- **NEVER** adjust the force settings to adjust for damage, including an unbalanced door, binding door track or broken spring.

⚠ CAUTION

DO NOT adjust force level above what is necessary to allow for normal door operation.

⚠ AVERTISSEMENT

Pour éviter les blessures ou des dommages

- **NE JAMAIS** régler la force pour compenser des dommages, y compris une porte mal équilibrée, un rail de porte coinçant ou des ressorts cassés.

⚠ CAUTION

NE réglez PAS la force à un niveau supérieur à ce qui est nécessaire pour permettre un fonctionnement normal de porte.

⚠ IMPORTANT NOTICE ⚠

IF FORCE SETTING IS ALTERED, ALL STEPS ON PAGE 29 MUST BE PERFORMED TO SET THE FORCE PROFILE FOR PROPER DOOR OPERATION.

Force Settings:

Force settings are pre-programmed at the factory to force level 6 (See Chart Below) and applied during the Open/Closed Limit settings steps. For normal use, these settings should not need adjustment.

Conditions possibly requiring adjustments are:

- Doors with very stiff weather seals.
- Doors that start down, stop, and reverse before closing.
- Doors that start up, but stop before they completely open.

1. Press and hold both UP & DOWN arrow buttons until the round LED turns red. Release buttons.
 - LEDs will show current force level (see chart).
2. Press either the UP or DOWN arrow button until the desired up force setting is shown (see chart).
3. Press & release the PRGM button to lock the desired up force setting.
 - Both LEDs will turn blue then go out confirming that the up force setting has been changed and is locked.
 - LEDs will now show the current down force setting (see chart).
4. Press either the UP or DOWN arrow button until desired DOWN force setting is shown (see chart).
5. Press & release the PRGM button to lock the desired down force setting.
 - Both LEDs will turn blue then go out confirming that the down force setting has been changed and is locked.
6. Perform all steps on page 29 to test operator.

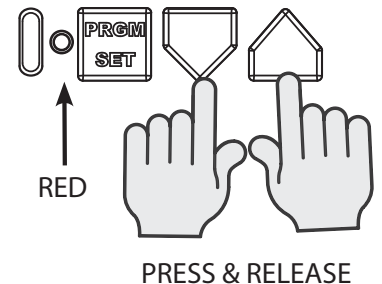

See Chart for Force level indicators.



Press PRGM to lock settings

FORCE SETTING CHART		
Force Level	Long LED	Round LED
1 (LOWEST)	OFF	BLUE
2	BLUE	OFF
3	BLUE	BLUE
4	OFF	PURPLE
5	PURPLE	OFF
6	PURPLE	PURPLE
7	OFF	RED
8	RED	OFF
9 (HIGHEST)	RED	RED

SPECIAL INSTALLATION INFORMATION

Clearing Memory of Remote Controls

NOTE: Clearing memory of remotes from the powerhead will clear ALL programmed remotes, wireless keypads and vehicle transmitters. The operator will no longer recognize any signal from any remote device, including a missing remote device. This does not include the Aladdin Connect® or wireless wall console.

All remaining (or recovered) remotes, vehicles and wireless keypads MUST be reprogrammed.

1. Press and hold the SET/PRGM button on the operator for 2-5 seconds.
 - The round LED will turn blue. Release button.
 - The long LED will then flash purple.
2. Press and hold the UP & DOWN buttons 2-5 seconds until both LEDs turn blue then release.
3. Both LEDs will turn off indicating that all remotes have been erased.
4. Press any remote button.
5. The operator should NOT run.

1. Enter Programming Mode

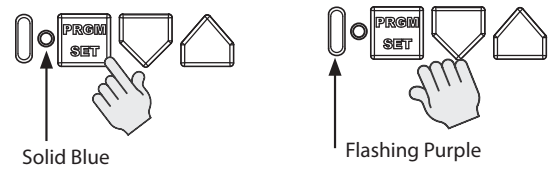

2. Press and Hold UP & DOWN Buttons 2-5 seconds

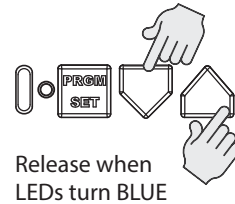

3. Test Remote

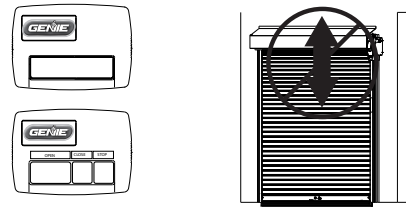

Clearing Memory of Wireless Wall Console

1. Press and hold the SET/PRGM button on the operator for 2-5 seconds.
 - The round LED will turn blue. Release button.
 - The long LED will then flash purple.
2. Press and hold the UP & DOWN buttons 10+ seconds until both LEDs turn green then release.
3. Both LEDs will turn off indicating that all wireless wall consoles have been erased.
4. Press wall console button.
5. The operator should NOT run.

1. Enter Programming Mode

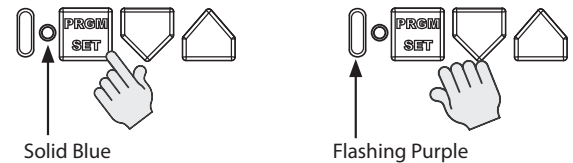

2. Press and Hold UP & DOWN Buttons 10+ seconds

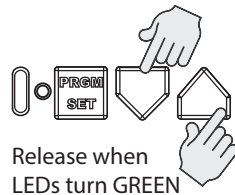

3. Test Wireless Wall Console

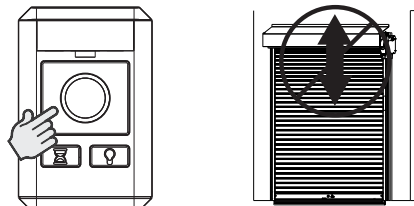

SPECIAL INSTALLATION INFORMATION

Installing Safe-T-Beams® on multiple garage doors (Preventing “cross-talk”)

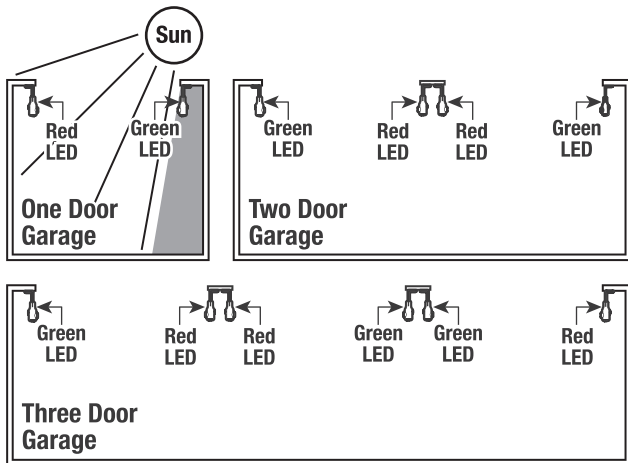

Multiple Garage Doors

- NEVER position Safe-T-Beam® modules where signals will cross.
- Place the Transmitter (Red LED) Safe-T-Beams on adjacent doors facing in opposite directions.

NOTE: Direct sunlight creates interference with Safe-T-Beam® Receiver (Green LED). STB modules CAN be positioned further away from the door opening if necessary to avoid sunlight, but no further off the wall to maintain alignment with the Transmitter (Red LED) module.

Single Garage Door

- Determine which side of the garage receives direct sunlight.
- Position the Transmitter (Red LED) on the direct sunlight side.

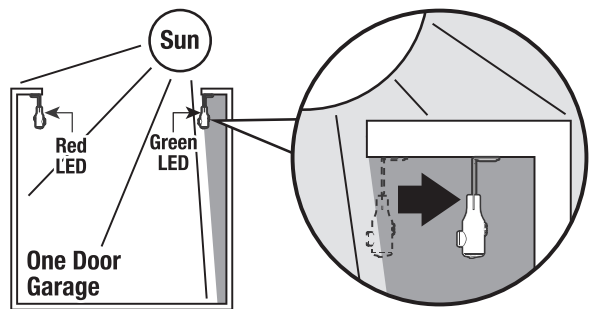

NOTE: Only use Safe-T-Beams® that are approved for use with this operator.

Safe-T-Beam® Self-Diagnostic Troubleshooting Chart

Source (RED LED)	Sensor (GREEN LED)	Possible Problem	Solution
ON	ON	Normal Operation	None Required
OFF	OFF	Operator not powered Wiring from operator bad	Check breakers, fuses, plugs Check wiring for shorts
OFF	ON	Wiring to source missing or bad Power has been interrupted	Check wiring Remove power and reapply
2 BLINKS	ON	Beam not aligned Beam obstructed Sensor defective	Check source, Sensor alignment Check for obstruction Contact Customer Support
2 BLINKS	OFF	Wire to sensor missing or bad Sensor defective	Check wiring Contact Customer Support
3 BLINKS	ON	Sensor receiving interference	Determine source of interference Contact Customer Support

SETTING UP ALADDIN CONNECT® (Optional Kit)

Perform these steps only after operator is fully installed, programmed, and tested.

IMPORTANT SAFETY INSTRUCTIONS

WARNING

TO REDUCE THE RISK OF SEVERE INJURY OR DEATH, READ AND FOLLOW ALL INSTRUCTIONS.

1. Never allow children to operate or play with door controls.
2. Install the entrapment WARNING placard next to the wall control in a prominent location.
3. NO PERSONS SHOULD CROSS THE PATH OF A MOVING DOOR.
4. NEVER GO UNDER A STOPPED/PARTIALLY OPEN DOOR.
5. The Aladdin Connect® operating system is designed for unattended operation. The door could move unexpectedly.

SAVE THESE INSTRUCTIONS

CONSIGNES DE SÉCURITÉ IMPORTANTES

AVERTISSEMENT

POUR RÉDUIRE LE RISQUE DE BLESSURES GRAVES VOIRE MORTELLES, LIRE ET COMPRENDRE TOUTES LES INSTRUCTIONS.

1. NE JAMAIS laisser les enfants utiliser ou jouer avec les commandes de l'ouvre-porte.
2. Placer l'étiquette d'AVERTISSEMENT en cas de coincéage à proximité du bouton mural ou de la console murale de manière à ce qu'elle soit bien en évidence.
3. NE JAMAIS PASSER SOUS LA PORTE EN MOUVEMENT.
4. NE JAMAIS PASSER SOUS UNE PORTE À L'ARRÊT PARTIELLEMENT OUVERTE.
5. Le système d'exploitation Aladdin Connect™ a été conçu pour fonctionner sans surveillance. La porte peut se déplacer de façon inattendue.

CONSERVER CES INSTRUCTIONS

Genie® Aladdin Connect® Accessory

The Aladdin Connect® system is a convenient mobile device app to operate garage door operators/controllers from anywhere.

The Aladdin Connect® app has the following features:

- Customize access for different users.
- Customize notifications to receive alerts when the garage door is operated, by a specific user, at a specific time or day.
- Review history of operator usage showing dates and times when the operator was operated and by what user.
- Create custom rules to notify you or close the door at specific times or if you door is open for a specific duration.
- Connect your operator to operate with smart home platforms.

⚠ IMPORTANT NOTICE ⚠

*This application must be used with the Bluetooth® LED Light Fixture Kit (part number 41151R).
See installation instructions on Page 20.*

1 Check Wi-Fi Signal

Before beginning the set-up process, please verify the ability to receive a strong Wi-Fi signal in the garage. Connect smartphone to the home Wi-Fi and walk into the garage. Place phone where garage door operator will be mounted. The Wi-Fi signal strength at that location must be at least two bars.

If home Wi-Fi signal does not adequately cover the garage, try the following steps to help improve the signal strength.

- Make sure that the Wi-Fi router is out in the open, not behind large electronics or in a cabinet.
- Moving the Wi-Fi router closer to the garage.
- Purchase a Wi-Fi extender, available at most electronics stores.

Device Wi-Fi Signal Strength Indicator



SETTING UP ALADDIN CONNECT® (Optional Kit)

2 Install optional kit into operator

- Follow instructions provided with the kit to install Aladdin Connect® (iDCM) circuit board.
- Attach decals provided with the kit to the front panel of operator and the front cover of this manual.

3 Download the Aladdin Connect® app (Unless using 3rd party app)

Scan for iOS app



Apple and the Apple logo are trademarks of Apple Inc., registered in the U.S. and other countries. App Store is a service mark of Apple Inc.

Scan for Android app



4 Follow the Aladdin Connect® app instructions

Follow steps per the app instructions.

- Create an account
- Add a device
- Set up Wi-Fi
- Add users and rules

For help at any time, contact The Genie Company at 1-866-599-4995 or visit our website. www.geniecompany.com/aladdinconnect

5 Install WARNING Placard

Once the app configuration is complete, open the door with the wall control, wait 10 seconds, and then close the door and wait 10 seconds. Look at the door status (open or closed) in the app. If the door status is not correct repeat the opening, pausing 10 seconds, closing, and pausing 10 seconds a few times until the door status displays correctly in the app.

Place included unintended operation warning placard next to garage door operator's wall button.

NOTE: This placard should be used in lieu of the standard WARNING placard included with this operator.



NOTE: Use of this product, the software embedded within this product and the related application software is subject to the Terms and Conditions available at: www.geniecompany.com/aladdinconnect

INSTALL & PROGRAM KEYPAD (abbreviated)

QuickView Single Door Setup

Please see complete instructions that accompany keypad.

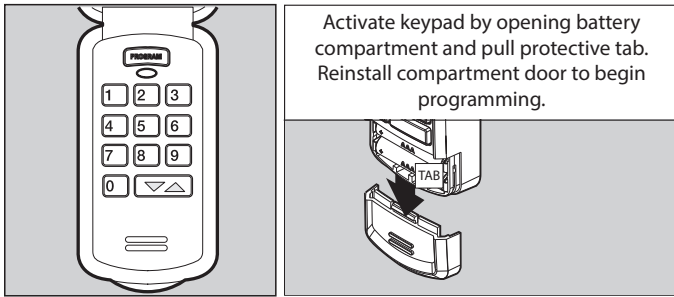

Activate keypad by opening battery compartment and pull protective tab. Reinstall compartment door to begin programming.

Program keypad before mounting.

1 Programming a PIN Number (Single Door)

NOTE: The existing factory default Personal Identification Number (PIN) for this keypad is the number sequence: 3-5-7.

Sync the operator and the keypad by performing the following:

1. Ensure the keypad back lighting is off.
2. Place garage door operator into remote control PROGRAMMING MODE (see section 4).
3. Press 3-5-7 in sequence on the keypad.
4. Press the UP/DOWN key 3 to 4 times slowly until garage door operator operates.
 - This completes the programming of a single door operator (door 1) and keypad.
 - **IT IS RECOMMENDED THAT YOU CHANGE THIS PIN FROM THE EXISTING FACTORY DEFAULT SETTING of 3-5-7. See STEP 2 below.**

2 Changing Default PIN Of 3-5-7

1. Enter the factory default pin -3-5-7.
2. Press PROGRAM key once.
3. Enter a new PIN of your choice (3-8 digits).
4. Press PROGRAM key once.
 - Your PIN has been changed and your previous PIN will no longer operate the keypad or operator.

3 Operating the Keypad with the Operator

Single Door Operation:

1. Ensure number pad back lighting is off.
2. Enter PIN number.
3. Press the UP/DOWN key.
4. Operator will operate.

NOTE: Keypad will remain active for 15 seconds after a successful entry is made. During this 15 seconds ANY key will operate the operator.

Resetting a PIN

Press and hold both the PROGRAM key and the Up/Down key for about five seconds.

The LEDs will slowly blink and then go out. When the LED stops blinking, the old programming has been successfully erased.

To create a new PIN, start with STEP 1.

Mounting Keypad

The keypad **MUST** be mounted within sight of the garage door(s) at least five feet above the floor and clear of any moving door part.

1. Remove battery cover and batteries.

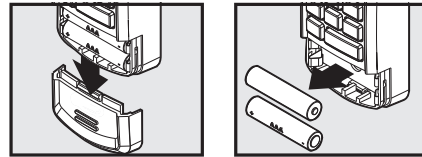

2. Drill 3/32" pilot hole for the top mounting screw (included).
3. Install a screw into the pilot hole, leaving a 1/8" gap between the screw head and wall.

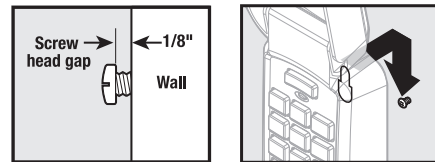

4. Hook the slotted mount, on back of keypad, over the screw.

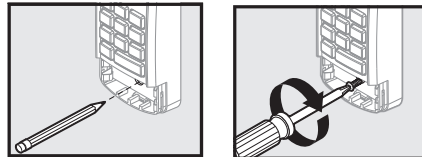

5. Mark and drill a pilot hole for the bottom screw (included) and secure keypad to wall (DO NOT overtighten).
6. Reinstall batteries and cover.

PROGRAMMING VEHICLE CONTROLS *(abbreviated)*

Programming HomeLink® System

1 Clear HomeLink

Clear HomeLink by pressing and holding down the first and third buttons until the indicator on the HomeLink blinks slow and then fast for 20 seconds; then release both buttons.

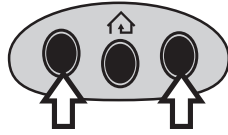

NOTE: *Clearing the HomeLink will remove all previously programmed garage door operators.*

2 Train HomeLink to the Remote

Choose the button on the HomeLink that will be used to open the door.

NOTE: *Hold the Remote two inches from the HomeLink button.*

Hold down the remote button. While holding, press and hold the chosen HomeLink button.

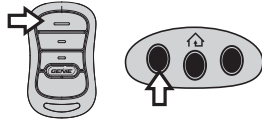

Hold down both buttons until the indicator on the HomeLink blinks slow then fast. Once it blinks, release both buttons.

3 Program HomeLink to the Operator (Place operator into programming mode) - SEE SECTION 4

A. Press the chosen HomeLink button for two seconds and release. Press that same button again for two seconds and release. The long LED will flash blue and then turn off.

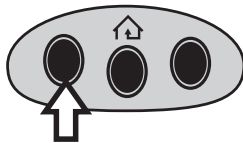

B. Press the HomeLink button a few more times until door moves.

NOTE: *For additional instructions, see the motor vehicle manual, or visit www.homelink.com or visit www.geniecompany.com*

Programming Car2U® System

1 Clear Car2U to Default Settings

The default setting for the Car2U system is:

- Button 1 = Genie®
Manufactured Operators
- Button 2 = LiftMaster®
Manufactured Operators
- Button 3 = Wayne Dalton®
Manufactured Operators

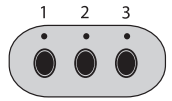

- A. Press and hold buttons 1 and 3 for 20 seconds or until all three LEDs begin to flash.
- B. Release both buttons. The Car2U system is now set to the Factory Default settings.

NOTE: *Clearing the Car2U remote will remove all previously programmed garage door operators.*

2 Program Car2U to the Operator (Place operator into programming mode) - SEE SECTION 4

- A. Press the designated Car2U button for two seconds and release. Press that same button again for two seconds and release. The long LED will flash blue and then turn off.
- B. Press the Car2U button a few times more until door moves.

3 Changing Factory Default Button for a Genie® Operator

- A. Press and hold buttons 1 & 3 for one second and release—all three LEDs will light solid red.
- B. Press and hold the button (2 or 3) to change it to—the corresponding LED will flash. While continuing to hold that button, press and release button 1. Press and release button 1 again.
- C. Release the button being held in step B and wait for the LED to stop flashing. This button is now set. Repeat Step 2 for second operator.

IMPORTANT SAFETY INSTRUCTIONS

⚠ WARNING

To reduce the risk of severe injury or death, read and follow all instructions.

1. **NEVER** let children operate or play with the door controls.
2. Keep remote away from children.
3. **ALWAYS** keep the moving door in sight and away from people and objects until door is completely closed. **NO ONE SHOULD CROSS THE PATH OF THE MOVING DOOR.**
4. **NEVER GO UNDER A STOPPED, PARTIALLY OPEN DOOR.**
5. Test operator monthly. The door **MUST** reverse on contact with a 1-1/2" high object (or 2" x 4" board laid flat) at the center of the doorway on the floor. After adjusting either the force or limit of travel, retest door operator. Failure to adjust the operator properly may cause severe injury or death.
6. When possible, use emergency release only when door is closed. Use caution when using this release with the door open. Weak or broken springs are capable of increasing the rate of door closing and increasing the risk of severe injury or death.
7. **KEEP DOORS PROPERLY BALANCED.** See your garage door Owner's Manual. An improperly balanced door increases the risk of severe injury or death. Have a trained door system technician make repairs to cables, spring assemblies, and other hardware.
8. This operator system is equipped with an unattended operation feature. The door could move unexpectedly. **NO ONE SHOULD CROSS THE PATH OF THE MOVING DOOR.**

SAVE THESE INSTRUCTIONS

IMPORTANTES CONSIGNES DE SÉCURITÉ

⚠ AVERTISSEMENT

Pour réduire le risque de blessures graves voire mortelles, lire et comprendre toutes les instructions.

1. **NE JAMAIS** permettre aux enfants d'actionner ou de jouer avec les commandes de la porte.
2. Tenir les télécommandes hors de la portée des enfants.
3. **TOUJOURS** garder en vue la porte en mouvement et tenir à l'écart toute personne ou objet jusqu'à ce que la porte soit totalement fermée. **PERSONNE NE DOIT TRAVERSER LA TRAJECTOIRE D'UNE PORTE EN MOUVEMENT.**
4. **NE JAMAIS PASSER SOUS UNE PORTE À L'ARRÊT PARTIELLEMENT OUVERTE.**
5. Tester l'ouvre-porte une fois par mois. La porte de garage **DOIT** inverser sa course au contact d'un objet de 4 cm (planche de 5 sur 10 cm) posé à plat sur le sol au centre de l'ouverture de la porte. Après avoir réglé la force ou la limite de la course, retenter l'ouvre-porte de garage. Un mauvais réglage de l'ouvre-porte peut entraîner des blessures graves voire mortelles.
6. Utiliser, dans la mesure du possible le déclenchement d'urgence uniquement lorsque la porte est fermée. Utiliser le déclenchement d'urgence avec prudence lorsque la porte est ouverte. Des ressorts faibles ou brisés peuvent faire descendre la porte rapidement ce qui peut entraîner des blessures graves voire mortelles.
7. **VEILLER À CE QUE LA PORTE SOIT CORRECTEMENT ÉQUILIBRÉE.** Consulter le manuel du propriétaire de la porte de garage. Une porte déséquilibrée pourrait entraîner de graves blessures voire mortelles. Demander à un technicien spécialisé en système de portes de se charger des réparations des câbles, des ressorts et de toute autre quincaillerie.
8. Ce système d'ouvre-porte est muni d'une fonction d'activation sans surveillance. La porte pourrait bouger sans que vous vous y attendiez. **IL NE FAUT JAMAIS PASSER DANS LA TRAJECTOIRE D'UNE PORTE EN MOUVEMENT.**

CONSERVER CES INSTRUCTIONS

⚠ WARNING

- Use of any other wall control can cause unexpected operation of the door and loss of lighting feature.
- Locate wall console within sight of the door but far enough from door to prevent contacting it while operating the console.
- Control must be at least 5' above the floor to prevent small children from operating it.

⚠ AVERTISSEMENT

- L'utilisation d'une autre commande murale pourrait produire des résultats inattendus de la porte ainsi que le dysfonctionnement de l'éclairage.
- Localisez la console murale en vue de la porte et suffisamment loin de la porte pour éviter tout contact pendant l'utilisation de la console.
- La commande doit être à une hauteur minimale de 1,5 m au-dessus du sol afin que les jeunes enfants ne puissent pas l'atteindre.

MAINTENANCE

Regular inspection/maintenance for the door and operator should be performed at regular intervals to ensure the system runs at peak safety, performance and efficiency.

MAINTENANCE ITEM	INTERVALS	DETAILS
Safe-T-Beam® system check	Monthly	Check wiring for loose connections, cracks or worn insulation. Clean lenses of dirt & debris.
Door Balance	Monthly	See Maintenance Detail A
Battery Backup System	Monthly	Unplug operator from outlet. Test operator with remote or wall console. Replace battery if needed.
Remote Battery replacement	As Needed	See Maintenance Detail B

A) Door Inspection

With the door closed, pull manual emergency release handle DOWN to disengage operator from door.

- Raise and lower the door manually. Door should move freely and smoothly.
 - Raise door manually about 3' to 4' from floor and let go. Door should slowly drift closed. Fig. 1.
- If door opens or closes rapidly, CONTACT A TRAINED DOOR SYSTEM TECHNICIAN to have your door springs serviced.
- Close the door.
 - Pull emergency release cord down and release quickly to engage operator to door.
 - Operate door using remote or wall control.

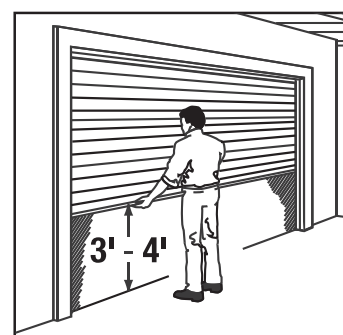

Fig.1

⚠ WARNING

- Garage door hardware (springs, cables, brackets, pulleys, etc.) are under extreme pressure and tension.
- **DO NOT** attempt to repair or adjust door springs or any hardware, and **DO NOT OPERATE** garage door automatically or manually if door is improperly balanced or springs are broken.
- **CONTACT A TRAINED DOOR SYSTEM TECHNICIAN.**

⚠ AVERTISSEMENT

- La quincaillerie de la porte de garage (ressorts, câbles, supports, poulies, etc.) sont sous des pressions et des tensions extrêmes.
- **NE PAS** réparer ni régler les ressorts de la porte ou toute autre pièce de quincaillerie et **NE PAS ACTIONNER** la porte manuellement ou automatiquement si elle n'est pas correctement équilibrée ou si des ressorts sont cassés.
- **CONTACTEZ UN TECHNICIEN SPÉCIALISÉ EN SYSTÈME DE PORTES.**

B) Replacing Batteries

Remote Battery Replacement (Commercial style transmitters)

Replace remote battery with a CR2032 coin cell battery.

1. Remove visor clip.
2. Remove phillips head screw from back of remote.
3. Squeeze ends of remote case inward to separate halves.
4. Replace battery. Be sure positive side (+) is UP.
5. Align components and snap case closed, replace screw and visor clip.

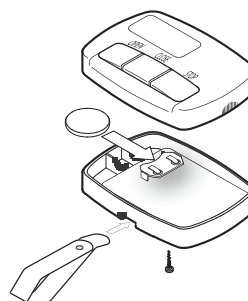

Wall Console Battery Replacement

Replace wall console batteries with 2-AAA batteries.

1. Open remote case.
2. Replace batteries. Ensure insertion in correct polarity.
3. Align components and snap case closed.

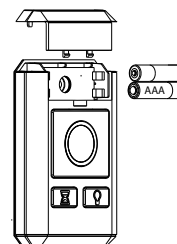



Need help or have questions? Call Genie® at 1-800-35-GENIE or visit: www.geniecompany.com

Operator does NOT operate when wall control is pressed

- Replace Wireless Wall Console Batteries, see page 41.
- If applicable, turn Sure-Lock™ off with basic wall console, see page 21
- If power is OK, check connections at powerhead terminals.
- Check for reversed, broken or cut wires. Staples can cut insulation and short wires. Repair or replace.

Operator runs, but door does not move

- Ensure coupler set screws have not loosened, see pages 8-13.

Operator works from wall control, but NOT from remote

- Check all remotes.
- Replace remote battery, see page 41.
- Program remotes to powerhead, see page 30.

Remote has less than 25 feet operating range or no operation

- Relocate remote inside car and /or point remote at garage door.
- Replace remote battery, see page 41.
- Eliminate possible competing signals (radio, etc.).

Door starts down, reverses - Safety device malfunction

- If new Installation, make sure only approved safety devices are installed.
- Check if limits are properly set, see pages 27-28. Adjust limits as needed.
- Check if Safe-T-Beam® red LED is flashing. See page 35, Safe-T-Beam® system check.
- Check Safe-T-Beam® system for beam obstruction or misalignment of lenses. See page 35, Safe-T-Beam® system.
- Check garage door for binding.
- Disconnect operator and try to manually close the door.
- If an operational problem exists, and operator will not close, the operator can be forced to close as follows:
Press and hold the wall control button until door is completely closed.
- Check for interference from adjacent safety device unit, see page 35.
- Contact Genie customer care.

Door starts down and stops before close limit. Door only opens

- Check safety device wire connection at powerhead and at device. See page 10/35, Safe-T-Beam® system check.
- Check if limits are properly set, see pages 27-28. Adjust limits as needed.
- Check garage door for binding. See maintenance and adjustment. Page 41.
- Check closing force control, see page 29, and force settings page 33.

TROUBLESHOOTING

Door starts up but STOPS before it is completely open

- Check if limits are properly set, see pages 27-28. Adjust limits as needed.
- Be sure door, operator, springs are in good repair, properly lubricated and balanced. Page 41.
- Disconnect operator and try to manually open the door.
- Check closing/opening force control, see page 29, and force settings page 33.
- If you suspect a problem with the garage door hardware or springs, visit www.geniecompany.com and use the "dealer locator" to find a local door service professional. NEVER try to repair door hardware or springs yourself.

Door will only run closed

- If applicable, turn Sure-Lock™ off with basic wall console, see page 21.
- Check if limits are properly set, see pages 27-28.
- Check door balance, condition, and door spring, see page 41.
- Check opening force control, see page 29, and force settings page 33.
- If you suspect a problem with the garage door hardware or springs, visit www.geniecompany.com and use the "dealer locator" to find a local door service professional. NEVER try to repair door hardware or springs yourself.

Door operator starts for no reason

- Button stuck on wall control or remote.
- Was remote lost or stolen? Erase all remotes from powerhead memory and program new remotes, see page 34 and 30.

Noisy operation

- Be sure all door fasteners are tight, see page 41.
- Be sure garage door is in good repair, properly lubricated and balanced, see page 41.
- Be sure operator is in good repair.

Door operator runs slow

- Check door balance, see page 41.
- Check operating condition of door. Door may need professional repair/adjustment.
- Check door type mode is correct for door type.
- If door is running slow in the close direction (approx. 11RPMs of the operator output shaft), check that the limits are set farther apart than 3.5 turns of the output shaft. If the limits are set at 3.5 turns apart or less, the operator will automatically set DOOR TYPE MODE 1 (see page 25) and will run at the slowest speed. If possible, set the limits to farther than 3.5 turns or greater apart and then reselect the DOOR TYPE MODE per instructions on page 25.

Mid Stop not setting / functioning properly

- Ensure that the mid stop is being set greater than 2 full turns of the output shaft below the open limit.
- Ensure that the mid stop is being set greater than 1/2 turn of the output shaft above the close limit
- Mid stop is cancelled/deleted when either the open or close limit is reset.

TROUBLESHOOTING

POWERHEAD LEDS

Powerhead LED		Possible Problem	Solution
Long LED	Round LED		
OFF	OFF	Normal operation.	None required.
		No response from unit.	Check power supply. Contact a trained door system professional.
ON/RED/ STEADY	ON/RED/ STEADY	Limits NOT set properly.	Re-program limits, see pages 27-28.
ON/RED/ FLASHING	ON/RED/ FLASHING	Program error.	Unplug unit, wait 5 seconds, plug in.
		Component failure.	Contact a trained door system technician.
OFF	ON/BLUE/ FLASHING	Remote NOT programmed.	Program remote, see page 30.
OFF	ON/PURPLE/ FLASHING	Remote NOT programmed.	Program remote, see page 30.
OFF	ON/RED/ FLASHING	Safe-T-Beam® physical obstruction.	Remote obstruction, recheck unit.
		Safe-T-Beam® signal interference.	Check alignment of Safe-T-Beam® pair and nearest other Safe-T-Beam® pair, see page 35.
ON/RED/ FLASHING	OFF	Door contact in UP or DOWN travel.	Remove obstruction.
		Door component failure detected.	Check door spring, track, rollers, hinges and fixtures.
ON/RED/ STEADY	OFF	Thermal cutout.	DO NOT unplug unit. Wait until LED clears before operating.
ALTERNATING YELLOW FLASH		Interlock Open	Check missing wire from interlock terminal Inspect interlock (see page 21)
ALTERNATING GREEN /RED FLASH		Ground to Stop Jumper missing	If unit is installed without an Open/Close/Stop pushbutton, jumper must be installed.
ON/PURPLE/ STEADY	ON/PURPLE/ STEADY	Component error.	Contact a trained door system technician.
ON/BLUE/ FLASHING	OFF	Door will not open.	Check Sure-Lock™. Sure-Lock™ should be OFF for normal operation (see page 21).
ON/PURPLE/ FLASHING	ON/PURPLE/ FLASHING	Radio receiver error.	Unplug the unit. Wait 5 seconds and plug the unit back in. If problems persist, contact a trained door system technician.
LED SIGNALS with BATTERY BACK-UP installed			
ON/GREEN STEADY	ON/GREEN STEADY	OK= Normal Operation. Charged, Battery Back Up	None Required
ON/GREEN FLASHING	ON/GREEN FLASHING	Discharging, Battery Back Up	Power is out. Battery in use.
ON/YELLOW FLASHING	ON/YELLOW FLASHING	Charging, Battery Back Up	None Required.
YELLOW FLASHING	RED FLASHING	Dead Battery, Battery Back Up	Replace Battery.

Specify model number of operator when ordering parts

DESCRIPTION	PART NUMBER
Hardware Bag (Staples, Safety Release Handle, Lag Screw, Jamb Bracket)	39946S.S
Hardware Bag (Lag Screw for Dead Shaft Mounting)	110891.0001
Coupler (Dead Shaft & Shutter)	39830R.S
Coupler w/Roll Pin (Live Shaft, Direct Couple)	42156R
Open/Close/Stop Push Button	106647.0001.S
Wireless Wall Console	39902R
Light Fixture	41151R
Mounting Brackets (Dead Shaft, Chain Couple)	112993.0001
Optional ACCESSORIES	PART NUMBER
Battery Backup Battery (Optional, Not Shown)	111658.0002.S
Battery Backup Housing (Optional, Not Shown)	41374R.S
Aladdin Connect® Wi-Fi Kit (Optional, Not Shown)	41153R
Low Voltage Power Input Kit (Not Shown)	41194R
Alternate Mounting Kit (Not Shown)(For use in Live Shaft & Shutter only)	40803R
Aladdin Connect® Kit (Not Shown)	41153R
Direct Couple Kit (Not Shown)	113312.0001.S
Dead Shaft Kit (Not Shown)	113295.0001

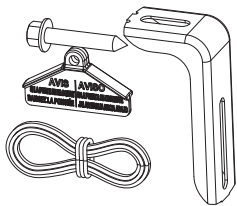

Hardware Bag (Staples,
Safety Release Handle,
Lag Screw, Jamb
Bracket)

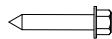

Hardware Bag
(Lag Screw)

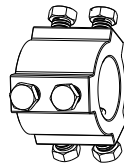

Coupler
(Dead Shaft &
Shutter)

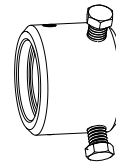

Coupler w/Roll Pin
(Live Shaft, Direct
Couple)

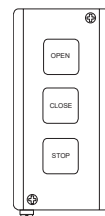

Open/Close/Stop
Push Button

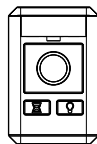

Wireless Wall Console

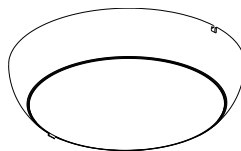

LED Light Fixture

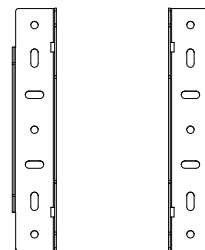

Mounting Brackets

REPLACEMENT PARTS

Specify model number of operator when ordering parts

ITEM	PART NUMBER	DESCRIPTION	QTY
1	39742A.S	Housing Cover	1
2	41181T.S	Main Control Board Kit	1
3	41184R.S	Transformer Kit	1
4	27335.P	Chain assembly, 16 Loop, 1/2" P	1
5	39547R.S	MLS (Travel Limit) Kit	1
6	39675R.S	Side Panel Assembly RH	1
7	39677R.S	Side Panel Assembly LH	1
8	39706A.S	Wire Tray Cover	1
9	41192R.S	Center Brace	1
10	41374R.S	Shaft Assembly Kit*	1
11	41374R.S	Motor Assembly Kit*	1
12	41374R.S	Release Assembly Kit*	1

* Due to the complexity of assembly, these kits require the 41374R.S Chassis Kit. Installer will use the chassis kit and install the cover assembly with circuit board(s), transformer assembly, and MLS assembly from existing operator.

REPLACEMENT PARTS

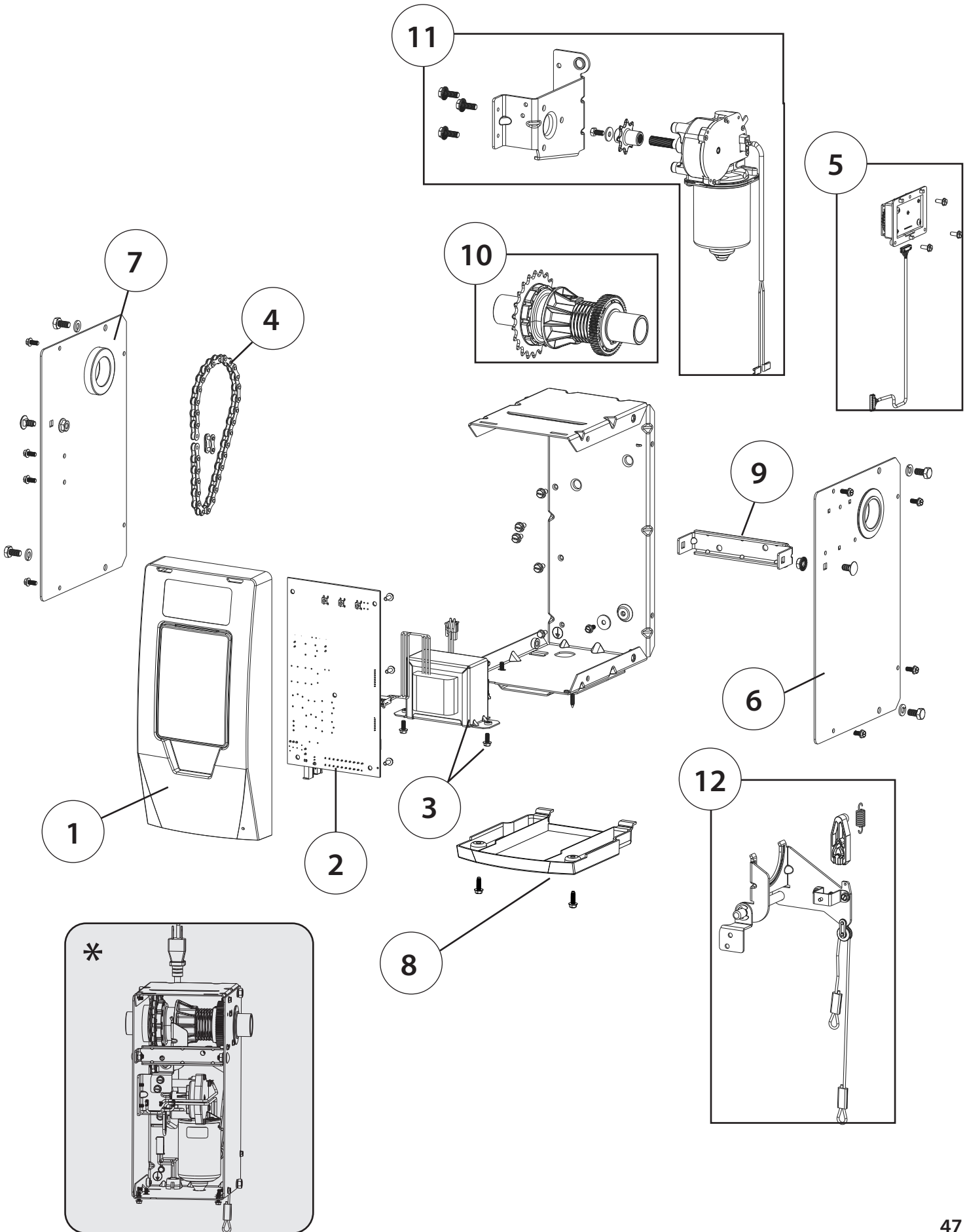

This page is intentionally left blank.



Commercial Operator Limited Warranty

The Genie Company ("Seller") warrants to the original purchaser of the GCL-LJ commercial door operator ("Product"), subject to all of the terms and conditions hereof, that the Product and all components thereof will be free from defects in materials and workmanship under normal use for the following period(s), measured from the date of installation.

Two (2) years or When the Operator exceeds 20,000 cycles of operation, as measured by the integrated cycle counter contained in the Operator.

Seller's obligation under this warranty is specifically limited to repairing or replacing, at its option, any part which is determined by Seller to be defective during the applicable warranty period. Any labor charges are excluded and will be the responsibility of the purchaser.

This warranty is made to the original purchaser of the Product only, and is not transferable or assignable. This warranty does not apply to any unauthorized alteration or repair of the Product, or to any Product or component which has been damaged or deteriorated due to misuse, neglect, accident, failure to provide necessary maintenance, normal wear and tear, or acts of God or any other cause beyond the reasonable control of Seller.

THIS WARRANTY IS EXCLUSIVE AND IN LIEU OF ANY OTHER WARRANTIES, EITHER EXPRESSED OR IMPLIED, INCLUDING BUT NOT LIMITED TO ANY IMPLIED WARRANTY OF MERCHANTABILITY OR FITNESS FOR A PARTICULAR PURPOSE.

IN NO EVENT SHALL SELLER BE RESPONSIBLE FOR, OR LIABLE TO ANYONE FOR, SPECIAL, INDIRECT, COLLATERAL, PUNITIVE, INCIDENTAL OR CONSEQUENTIAL DAMAGES, even if Seller has been advised of the possibility of such damages. Such excluded damages include, but are not limited to, loss of goodwill, loss of profits, loss of use, cost of any substitute product, interruption of business, or other similar indirect financial loss.

Claims under this warranty must be made promptly after discovery, within the applicable warranty period, and in writing to the Seller or to the authorized distributor or installer whose name and address appear below.

The purchaser must allow Seller a reasonable opportunity to inspect any Product claimed to be defective prior to removal or any alteration of its condition. Proof of the purchase and/or installation date, and identification as the original purchaser, may be required.



The Genie Company
1 Door Drive, Mount Hope OH. 44660
1-800-843-4084
www.geniecompany.com